

# **RCRA FACILITY INVESTIGATION**

## **QUARTERLY PROGRESS REPORT #25 SECOND QUARTER 2007**

**GM POWERTRAIN - BEDFORD FACILITY  
105 GM DRIVE  
BEDFORD, INDIANA**

**EPA ID# IND006036099**

**Prepared For:  
General Motors Corporation**

**JULY 13, 2007**

**REF. NO. 013968 (245)**

This report is printed on recycled paper.

TABLE OF CONTENTS

	<u>Page</u>
1.0 <u>INTRODUCTION</u> .....	3
2.0 <u>LIST OF COMPLETED ACTIVITIES</u> .....	4
3.0 <u>SUMMARIES OF ALL CHANGES MADE IN THE CORRECTIVE ACTION (CA) DURING THE REPORTING PERIOD</u> .....	7
4.0 <u>COMMUNITY RELATIONS</u> .....	8
5.0 <u>CHANGES IN PERSONNEL DURING THE REPORTING PERIOD</u> .....	9
6.0 <u>PROJECTED WORK FOR THE NEXT REPORTING PERIOD</u> .....	10
7.0 <u>COPIES OF DAILY REPORTS, INSPECTION REPORTS, LABORATORY/MONITORING DATA</u> .....	11

LIST OF FIGURES

FIGURE 2.1	EAST PLANT AREA AIR SAMPLING LOCATIONS
FIGURE 7.1	ADDITIONAL PARCEL 201 DELINEATION SAMPLES

LIST OF TABLES

TABLE 2.1	VALIDATED AIR MONITORING RESULTS - PCB
TABLE 7.1	PARCEL 201 ANALYTICAL RESULTS SUMMARY

LIST OF APPENDICES

APPENDIX A	EAST PLANT AREA CONSTRUCTION MEETING MINUTES
------------	--

**QUARTERLY PROGRESS REPORT**

**DISTRIBUTION LIST**

<b>U.S. EPA - Waste, Pesticide and Toxins Division, Project Manager</b>	<b>Peter Ramanauskas (2 copies)</b>
<b>U.S. EPA - Emergency Response Branch, On-Scene Coordinator</b>	<b>Brad Stimple</b>
<b>TN and Associates, U.S. EPA Consultant</b>	<b>Stacy DeLaReintrie</b>
<b>Earth Tech, U.S. EPA Consultant</b>	<b>John Bassett</b>
<b>Indiana Department of Environmental Management</b>	<b>Gerald O'Callaghan (5 copies)</b>
<b>U.S. Fish and Wildlife Service</b>	<b>Dan Sparks</b>
<b>GM WFG Remediation</b>	<b>Cheryl Hiatt/Ed Peterson</b>
<b>CRA, Project Coordinator</b>	<b>James McGuigan</b>
<b>CRA, Project Geologist</b>	<b>Bill Steinmann</b>
<b>CRA, Oversight Engineer</b>	<b>Katie Kamm</b>
<b>CRA, QA/QC Officer</b>	<b>Jeff Nichols (3 copies)</b>
<b>ENVIRON</b>	<b>Steve Song</b>

## 1.0 INTRODUCTION

This Quarterly Progress Report is submitted in accordance with the Bedford Performance-Based Corrective Action Agreement (Agreement) between the United States Environmental Protection Agency (U.S. EPA) and General Motors Corporation (GM), executed on March 20, 2001, and modified on October 1, 2002. This report covers the period of the second calendar quarter of 2007 for the GM Powertrain - Bedford Facility (Facility), Bedford, Indiana. Some of the activities conducted as part of the overall Resource Conservation and Recovery Act (RCRA) Corrective Action (CA) work are being addressed under the Comprehensive Environmental Response, Compensation, and Liability Act (CERCLA) Removal Action (RA) Program, pursuant to the Administrative Order on Consent (AOC) between the U.S. EPA and GM (effective July 31, 2003). These activities are described in more detail within the CERCLA Monthly Progress Reports referred to herein.

The next quarterly progress report, covering the Third Quarter 2007, will be submitted on or before October 15, 2007.

## 2.0 LIST OF COMPLETED ACTIVITIES

The following activities took place and the following documents were prepared and distributed during this quarter:

- Conference calls were held with the U.S. EPA, Indiana Department of Environmental Management (IDEM), the Agency for Toxic Substance and Disease Registry (ATSDR) and Indiana State Department of Health (ISDH) on April 10, and 24, 2007; May 9, and 22, 2007; and June 7, and 19, 2007, to discuss project progress (United States Fish and Wildlife Service (USFWS) was also invited to attend the update calls);
- Information sessions for the public were held at the Facility May 21, 2007, with residents along the trucking routes; and June 6 with the neighbors and June 7, 2007, with the general community to discuss project progress. The Community Liaison Panel (CLP) met June 8, 2007;
- Fact Sheet 16 was released to the Public and U.S. EPA on May 24, 2007;
- Air monitoring was conducted in the East Plant Area during construction activities. Air monitoring results completed for work in the East Plant Area are presented on Tables 2.1 (PCB). Figure 2.1 presents the sampling locations in the East Plant Area. PCB air monitoring results are reported to the U.S. EPA as the data become available;
- Response to U.S. EPA comments on the Vault Leak Detection System (LDS) were submitted April 18, 2007;
  - The U.S. EPA requested additional details of the LDS and vault construction May 9, 2007;
  - A response clarifying specifically how surface water may have entered the LDS was submitted May 29, 2007;
- Placement of creek RA <50 mg/kg PCB material in the East Plant Area continued during the Second Quarter of 2007;
- The final East Plant Area Cover System Design Report was submitted April 19, 2007:
  - Revised “Issued for Construction” drawings for the final Cover System, dated June 8, 2007, were submitted to the U.S. EPA and IDEM on June 25, 2007;
- Details regarding the planned non-aqueous phase liquid (NAPL) investigation for Area of Interest (AOI) 8 were emailed to the U.S. EPA on June 19, and 22, 2007.
- The fence around elevated sample results on Parcel 201 was expanded around additional sample locations, April 3, 2007, as sample results became available:

- A Parcel 201 delineation figure with preliminary laboratory results and an additional requested figure of the 1977 aerial photograph were submitted to the U.S. EPA and IDEM on April 17, 2007, and
- The U.S. EPA commented on and a response was submitted by GM clarifying the fencing around the P201 delineated area on April 18, 2007;
- The Final Draft Technical Memorandum, Addenda No. 3, 4, 5, 6, and 7 was submitted on May 3, 2007 to U.S. EPA and IDEM;
- Installation of new groundwater monitoring under the RFI Work Plan Addendum No. 13 was completed during this reporting period, as identified in the approved RFI Work Plan Addendum No. 13;
  - Groundwater sampling at newly installed wells at off-Site properties was completed. This sampling will continue into the next calendar quarter as new wells are installed and developed;
  - A figure showing the location of the new monitoring well on AOI 1 requested by the U.S. EPA was submitted May 22, 2007;
- IDEM approved GM's Section 401 Water Quality Certification (WQC) for the Northern Tributary IM remediation work on April 23, 2007;
  - An approval letter from U.S. Army Corps of Engineers to conduct the Northern Tributary IM in the stream was sent May 2, 2007;
- Excavation of a small additional delineated area along the Western Tributary on Parcel 53 began during June 2007;
- The West Plant IM Work Plan was submitted to the U.S. EPA and IDEM on April 24, 2007;
  - In response to U.S. EPA comments, revised databox figures for the West Plant Area IM Work Plan were submitted May 14, 2007, and
  - In response to additional U.S. EPA comments additional revisions to the metals databox figures were submitted to the U.S. EPA and IDEM June 8, 2007;
- Figures showing the buffer zones for the modified stockpiling plan for the re-use of <50 mg/kg PCB material from the RA were submitted to the U.S. EPA and IDEM on April 13, 2007; and
- East Plant Area construction meetings for the reporting period have been held informally daily and formally weekly. Meetings with ENTACT Environmental Services (ENTACT) and Severson Environmental Services (SES) to discuss the East Plant Area are generally held on Tuesdays. East Plant Area meetings were held on:

April 3, 10, and 17, 2007; May 1, 8, 15, 22, and 30, 2007; and June 5, 12, 19, and 26, 2007. Minutes of these meetings are attached in Appendix B.

The March 2007, April 2007, and May 2007 CERCLA RA Monthly Progress Reports were submitted during the first quarter of 2007. Quarterly Progress Report #24 for the First Quarter 2007 was submitted April 13, 2007.

### 3.0 SUMMARIES OF ALL CHANGES MADE IN THE CORRECTIVE ACTION (CA) DURING THE REPORTING PERIOD

The following changes were made to the CA during the reporting period:

- Submission of figures showing the buffer zones for the modified stockpiling plan on April 13, 2007;
- Approval of GM's Section 401 Water Quality Certification (WQC) for the Northern Tributary IM remediation work on April 23, 2007;
- Submission of Parcel 201 delineation preliminary laboratory results and an additional requested figure of the 1979 aerial photograph on April 17, 2007;
- Submission of Response to U.S. EPA comments on the Vault LDS on April 18, 2007;
- Submission to clarify the fencing around the P201 delineated area on April 18, 2007;
- Submission of the final East Plant Area Cover System Design Report on April 19, 2007;
- Submission of the West Plant IM Work Plan on April 24, 2007;
- Approval to conduct work in the stream as part of the Northern Tributary IM on May 2, 2007;
- Submission of the Final Draft Technical Memorandum, Addenda No. 3, 4, 5, 6, and 7 on May 3, 2007;
- Submission of revised databox figures for the West Plant Area IM Work Plan on May 14, 2007;
- Submission of AOI 1 Monitoring Well figure on May 22, 2007;
- Publication of Fact Sheet 16 on May 24, 2007;
- Submission of additional LDS clarification and construction details on May 29, 2007;
- Submission of revised "Issued for Construction" drawings for the final Cover System, on June 25, 2007; and
- Submission of additional revisions to the databox figures for the West Plant Area IM Work Plan on June 8, 2007;



#### 4.0 COMMUNITY RELATIONS

GM continues to maintain the toll free information telephone number. Individual meetings can also be arranged to discuss sampling results with individual residents as requested.

A meeting was held with residents who live along truck haul routes on May 21, 2007 to discuss trucking and road issues.

Quarterly meetings to review project status, are held both with the neighbors along the creek and around the plant, as well as with the general public. Quarterly meetings were held during this reporting period on June 6, and 7, 2007, at the Facility. The meetings were held from 6:30 PM to 8:00 PM at the Bedford Facility as a regular information session. Presentations for the meetings are posted on the web site at [www.bedfordpowertraincorrectiveaction.com](http://www.bedfordpowertraincorrectiveaction.com). The next set of public meetings has been tentatively scheduled for September 12, and 13, 2007.

Fact Sheet 16 was issued May 24, 2007.

The CLP meeting occurred in this quarter on June 8, 2007. The CLP was formed to provide additional communication avenues for the community and the meetings are currently being held at the GM Facility approximately every three months or more frequently if information on the project changes significantly. The CLP meeting minutes are posted on the GM website at [www.bedfordpowertraincorrectiveaction.com](http://www.bedfordpowertraincorrectiveaction.com). The next CLP meeting is scheduled for September 2007.

The Information Center, located at the plant lobby, is available by appointment through Ms. Becki Akers, GM Communications, at the project toll free number 866-223-0856. The repository located at the Bedford Public Library remains open at normal business hours. All data in the repository are also located on the aforementioned web site.

5.0 CHANGES IN PERSONNEL DURING THE REPORTING PERIOD

A number of field personnel have been rotated in and out of the field activities.

## 6.0 PROJECTED WORK FOR THE NEXT REPORTING PERIOD

Work projected for the next reporting period includes:

- Conducting a neighborhood information session tentatively on September 12, 2007;
- Conducting a general public information session tentatively on September 13, 2007;
- Conducting a Community Liaison Panel Meeting tentatively on September 14, 2007;
- Preparing and distributing Fact Sheet 17 in the next quarter;
- Continuing with RA activities on downstream parcels;
- Continuing the evaluation of RFI soil and groundwater data;
- Continuing evaluation of samples collected for RFI Work Plan: Addendum No. 13;
- Completing the Western Tributary IM Construction Certification Report;
- Commencing work as outlined in the Northern Tributary IM Work Plan;
- Commencing work as outlined in the West Plant Area IM Work Plan, pending Work Plan approval;
- Submitting an IM Work Plan for Parcel 400;
- Assessing delineation samples on Parcel 201 relevant to the Environmental Indicator (EI) CA 725 and preparing a Work Plan;
- Submitting an Interim EI CA 750 report in August 2007;
- Submitting additional data collected under the RFI Addendum No. 10 to the IDEM-Underground Storage Tank (UST) Division, along with a request for No Further Action (NFA) letter for the five former USTs;
- Commencing construction of the vault cover;
- Continuation of placement of the < 50 mg/kg PCB RA soils in the East Plant Area as grading fill beneath the landfill cover system; and
- Submitting an investigation work plan for the NAPL in and south of AOI 8.

**7.0 COPIES OF DAILY REPORTS, INSPECTION REPORTS,  
LABORATORY/MONITORING DATA**

Parcel 201 revised delineation sample locations are presented on Figure 7.1. Validated sample results are presented on Table 7.1

Packages of analytical data from creek remediation verification sampling have been submitted monthly as they become available, after validation, in the monthly reports prepared for the CERCLA AOC, and will continue to be submitted during the next reporting period. Any other sampling data collected during the quarter will be submitted under separate cover once validation is completed.

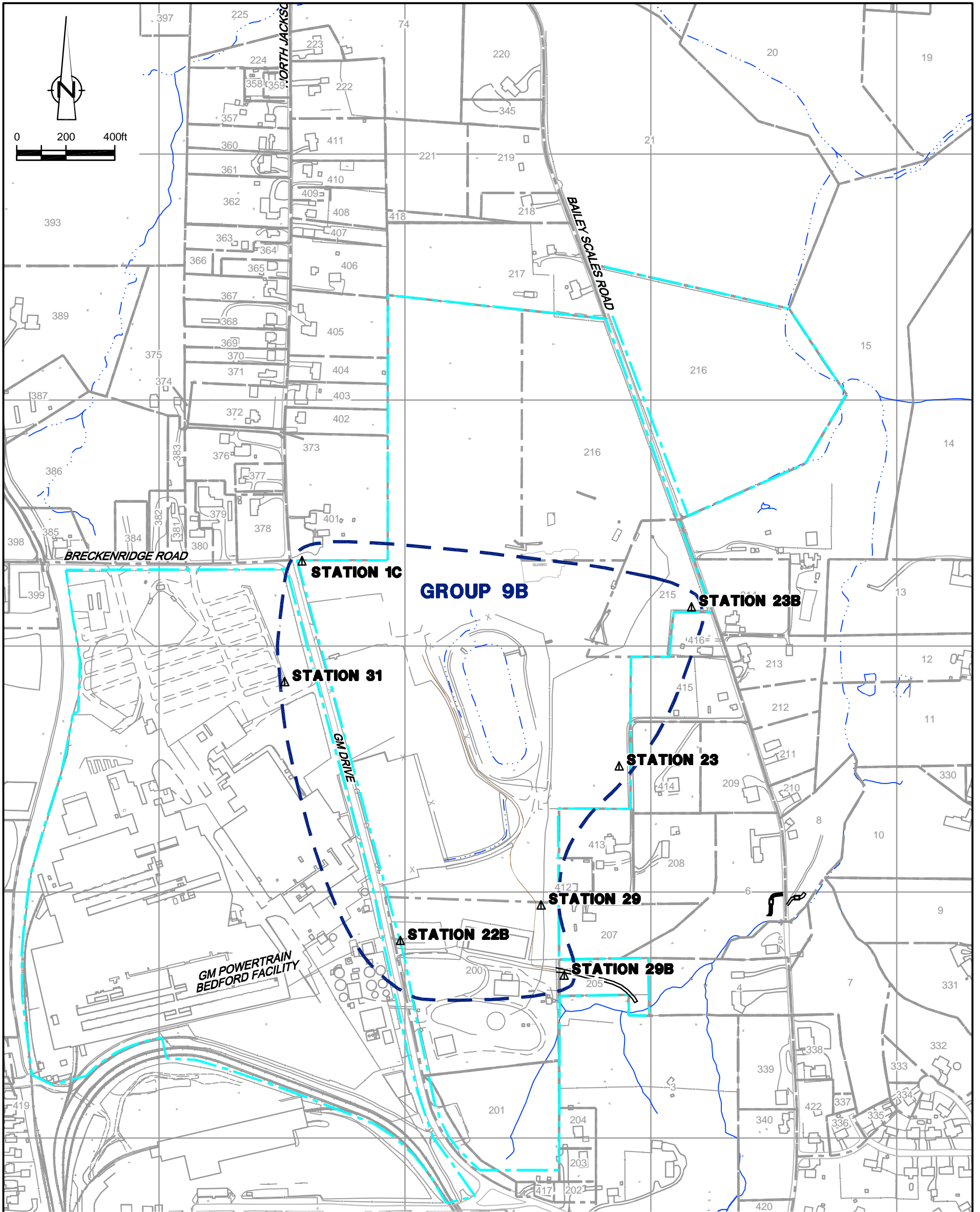

SOURCE: BASE MAP COMPLETED BY AIR-LAND SURVEYS, FLINT, MI, APRIL 2001.

NOTES: 1) PROPERTY BOUNDARY LOCATIONS APPROXIMATED FROM THE LAWRENCE COUNTY SURVEY PLATS. LOCATIONS MAY NOT ACCURATELY REPRESENT THE TRUE BOUNDARIES  
 2) STATIONS 23 AND 29 MOVED TO STATIONS 23B AND 29B, RESPECTIVELY, JUNE 2007

**LEGEND**

- |  |                                    |  |   |
|--|------------------------------------|--|---|
|  | EXISTING BUILDINGS                 |  | APPROXIMATE PARCEL BOUNDARY             |
|  | FENCE LINE                         |  | APPROXIMATE GM PROPERTY BOUNDARY        |
|  | RAILROAD TRACKS                    |  | <b>STATION 23</b> AIR SAMPLING LOCATION |
|  | DIRT ROADS                         |  | AIR SAMPLING GROUP                      |
|  | ROADS / PAVED AREAS                |  |   |
|  | APPROXIMATE SURFACE WATER LOCATION |  |   |

figure 2.1

**EAST PLANT AREA AIR MONITORING STATIONS  
 QUARTERLY PROGRESS REPORT No.25  
 GM POWERTRAIN BEDFORD FACILITY  
 Bedford, Indiana**



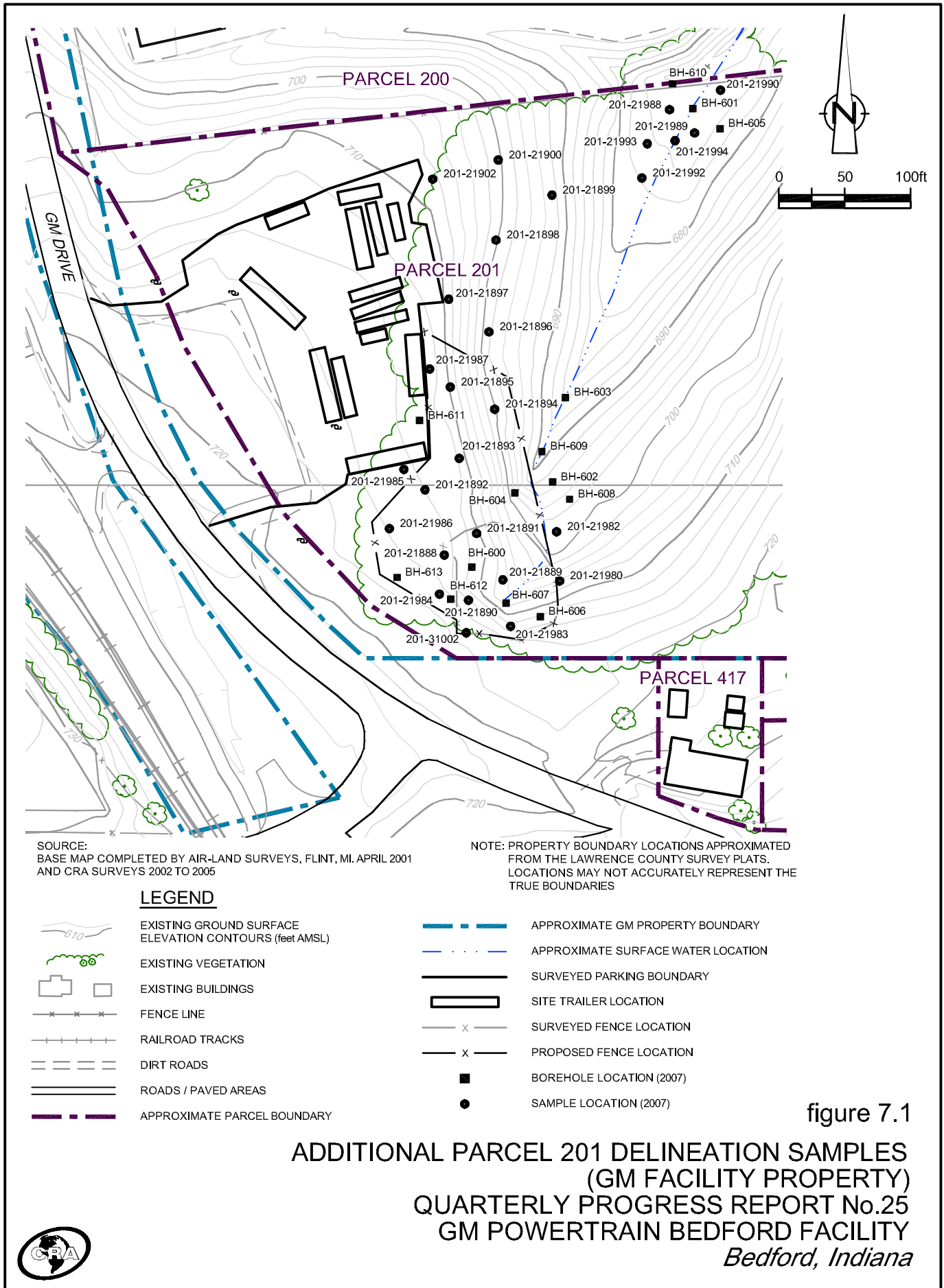

SUMMARY OF PCB AIR MONITORING ANALYTICAL RESULTS - APRIL, MAY AND JUNE 2007  
 GM POWERTRAIN BEDFORD FACILITY  
 BEDFORD, INDIANA

Unit_ID	STATION 1C PUF-16	STATION 22B PUF-18	STATION 23 PUF-2	STATION 31 PUF-6
<b>4/9/2007</b>				
Total Volume(m3)	NR	365	NR	NR
Total PCB Mass(ug)	NR	45	NR	NR
PCB Concentration(ug/m3)	NR	0.1233	NR	NR
Percent of Allowable(%)	NR	12	NR	NR
<b>4/24/2007</b>				
Total Volume(m3)	NR	NR	NR	407
Total PCB Mass(ug)	NR	NR	NR	76
PCB Concentration(ug/m3)	NR	NR	NR	0.1867
Percent of Allowable(%)	NR	NR	NR	19
<b>5/7/2007</b>				
Total Volume(m3)	412	NR	NR	NR
Total PCB Mass(ug)	110	NR	NR	NR
PCB Concentration(ug/m3)	0.267	NR	NR	NR
Percent of Allowable(%)	27	NR	NR	NR
<b>5/21/2007</b>				
Total Volume(m3)	440	NR	NR	NR
Total PCB Mass(ug)	20	NR	NR	NR
PCB Concentration(ug/m3)	0.0455	NR	NR	NR
Percent of Allowable(%)	5	NR	NR	NR
<b>5/30/2007</b>				
Total Volume(m3)	438	NR	NR	NR
Total PCB Mass(ug)	61	NR	NR	NR
PCB Concentration(ug/m3)	0.1393	NR	NR	NR
Percent of Allowable(%)	14	NR	NR	NR
<b>6/4/2007</b>				
Total Volume(m3)	NR	NR	359	NR
Total PCB Mass(ug)	NR	NR	5	NR
PCB Concentration(ug/m3)	NR	NR	0.0139	NR
Percent of Allowable(%)	NR	NR	1	NR
<b>6/11/2007</b>				
Total Volume(m3)	NR	397	NR	NR
Total PCB Mass(ug)	NR	160	NR	NR
PCB Concentration(ug/m3)	NR	0.403	NR	NR
Percent of Allowable(%)	NR	40	NR	NR

SUMMARY OF PCB AIR MONITORING ANALYTICAL RESULTS - APRIL, MAY AND JUNE 2007  
 GM POWERTRAIN BEDFORD FACILITY  
 BEDFORD, INDIANA

Unit_ID	STATION 1C PUF-16	STATION 22B PUF-18	STATION 23 PUF-2	STATION 31 PUF-6
<b>6/18/2007</b>				
Total Volume(m3)	423	NR	NR	NR
Total PCB Mass(ug)	90	NR	NR	NR
PCB Concentration(ug/m3)	0.2128	NR	NR	NR
Percent of Allowable(%)	21	NR	NR	NR
<b>6/26/2007</b>				
Total Volume(m3)	421	NR	NR	NR
Total PCB Mass(ug)	41	NR	NR	NR
PCB Concentration(ug/m3)	0.0974	NR	NR	NR
Percent of Allowable(%)	10	NR	NR	NR

Notes:

NR - No result because machine was not setup



TABLE 7.1

**PARCEL 201 SOIL SAMPLE ANALYTICAL RESULTS SUMMARY  
GM POWERTRAIN BEDFORD FACILITY  
BEDFORD, INDIANA**

<i>Sample Area:</i>	<i>P201</i>	<i>P201</i>	<i>P201</i>	<i>P201</i>	<i>P201</i>	<i>P201</i>	<i>P201</i>
<i>Sample Location:</i>	201-21888	201-21889	201-21890	201-21891	201-21892	201-21893	201-21894
<i>Sample Date:</i>	3/23/2007	3/23/2007	3/23/2007	3/23/2007	3/26/2007	3/26/2007	3/26/2007
<i>Sample ID:</i>	S-201-032307-BN-21888	S-201-032307-BN-21889	S-201-032307-BN-21890	S-201-032307-BN-21891	S-201-032607-CH-21892	S-201-032607-CH-21893	S-201-032607-CH-21894
<i>Depth</i>	(0-0.33)ft	(0-0.33)ft	(0-0.33)ft	(0-0.33)ft	(0-0.33)ft	(0-0.33)ft	(0-0.33)ft

<i>Parameters</i>	<i>Units</i>							
<i>PCBs</i>								
Aroclor-1016 (PCB-1016)	mg/kg	2.5 U	0.47 U	0.91 U	2.6 U	0.84 U	0.92 U	0.88 U
Aroclor-1221 (PCB-1221)	mg/kg	2.5 U	0.47 U	0.91 U	2.6 U	0.84 U	0.92 U	0.88 U
Aroclor-1232 (PCB-1232)	mg/kg	2.5 U	0.47 U	0.91 U	2.6 U	0.84 U	0.92 U	0.88 U
Aroclor-1242 (PCB-1242)	mg/kg	2.5 U	0.47 U	0.91 U	2.6 U	0.84 U	0.92 U	0.88 U
Aroclor-1248 (PCB-1248)	mg/kg	22	4.9	15	25	15	17	13
Aroclor-1254 (PCB-1254)	mg/kg	2.5 U	0.47 U	0.91 U	2.6 U	0.84 U	0.92 U	0.88 U
Aroclor-1260 (PCB-1260)	mg/kg	1.5 J	0.45 J	0.85 J	1.6 J	1.1	1.5	0.83 J
Total PCBs	mg/kg	23.5 J	5.35 J	15.85 J	26.6 J	16.1	18.5	13.83 J

## Notes:

U - Not present at or above the associated value.

J - Estimated concentration.

ND - Non-Detect

TABLE 7.1

**PARCEL 201 SOIL SAMPLE ANALYTICAL RESULTS SUMMARY  
GM POWERTRAIN BEDFORD FACILITY  
BEDFORD, INDIANA**

<i>Sample Area:</i>	P201		P201		P201		P201	
<i>Sample Location:</i>	201-21895	201-21896	201-21897	201-21898	201-21899	201-21900	201-21900	201-21900
<i>Sample Date:</i>	3/26/2007	3/26/2007	3/26/2007	3/26/2007	3/26/2007	3/26/2007	3/26/2007	3/26/2007
<i>Sample ID:</i>	S-201-032607-CH-21895	S-201-032607-CH-21896	S-201-032607-CH-21897	S-201-032607-CH-21898	S-201-032607-CH-21899	S-201-032607-CH-21900	S-201-032607-CH-21900	S-201-032607-CH-21901
<i>Depth</i>	(0-0.33)ft	(0-0.33)ft	(0-0.33)ft	(0-0.33)ft	(0-0.33)ft	(0-0.33)ft	(0-0.33)ft	(0-0.33)ft (Duplicate)
<i>Parameters</i>	<i>Units</i>							
<i>PCBs</i>								
Aroclor-1016 (PCB-1016)	mg/kg	0.86 U	0.044 U	0.042 U	0.044 U	0.048 U	0.051 U	0.053 U
Aroclor-1221 (PCB-1221)	mg/kg	0.86 U	0.044 U	0.042 U	0.044 U	0.048 U	0.051 U	0.053 U
Aroclor-1232 (PCB-1232)	mg/kg	0.86 U	0.044 U	0.042 U	0.044 U	0.048 U	0.051 U	0.053 U
Aroclor-1242 (PCB-1242)	mg/kg	0.86 U	0.044 U	0.042 U	0.044 U	0.048 U	0.051 U	0.053 U
Aroclor-1248 (PCB-1248)	mg/kg	17	0.4	0.27	1.1	0.13	0.087	0.011 J
Aroclor-1254 (PCB-1254)	mg/kg	0.86 U	0.044 U	0.042 U	0.044 U	0.048 U	0.051 U	0.053 U
Aroclor-1260 (PCB-1260)	mg/kg	0.98	0.057	0.038 J	0.17	0.042 J	0.051 U	0.053 U
Total PCBs	mg/kg	17.98	0.457	0.308 J	1.27	0.172 J	0.087	0.011 J

## Notes:

U - Not present at or above the associated

J - Estimated concentration.

ND - Non-Detect

TABLE 7.1

**PARCEL 201 SOIL SAMPLE ANALYTICAL RESULTS SUMMARY  
GM POWERTRAIN BEDFORD FACILITY  
BEDFORD, INDIANA**

<i>Sample Area:</i>	<i>P201</i>	<i>P201</i>	<i>P201</i>	<i>P201</i>	<i>P201</i>	<i>P201</i>	<i>P201</i>	
<i>Sample Location:</i>	201-21902	201-21980	201-21980	201-21982	201-21983	201-21984	201-21985	
<i>Sample Date:</i>	3/26/2007	4/3/2007	4/3/2007	4/3/2007	4/3/2007	4/3/2007	4/3/2007	
<i>Sample ID:</i>	S-201-032607-CH-21902	S-201-040307-CH-21980	S-201-040307-CH-21981	S-201-040307-CH-21982	S-201-040307-CH-21983	S-201-040307-CH-21984	S-201-040307-CH-21985	
<i>Depth</i>	(0-0.33)ft	(0-0.33)ft	(0-0.33)ft (Duplicate)	(0-0.33)ft	(0-0.33)ft	(0-0.33)ft	(0-0.33)ft	
<i>Parameters</i>	<i>Units</i>							
<i>PCBs</i>								
Aroclor-1016 (PCB-1016)	mg/kg	0.042 U	0.043 U	0.047 U	0.043 U	0.043 U	2.1 U	0.21 U
Aroclor-1221 (PCB-1221)	mg/kg	0.042 U	0.043 U	0.047 U	0.043 U	0.043 U	2.1 U	0.21 U
Aroclor-1232 (PCB-1232)	mg/kg	0.042 U	0.043 U	0.047 U	0.043 U	0.043 U	2.1 U	0.21 U
Aroclor-1242 (PCB-1242)	mg/kg	0.042 U	0.043 U	0.047 U	0.043 U	0.043 U	2.1 U	0.21 U
Aroclor-1248 (PCB-1248)	mg/kg	0.14	0.055	0.083	0.043 U	0.01 J	35	3.9
Aroclor-1254 (PCB-1254)	mg/kg	0.042 U	0.043 U	0.047 U	0.043 U	0.043 U	2.1 U	0.21 U
Aroclor-1260 (PCB-1260)	mg/kg	0.065	0.03 J	0.026 J	0.043 U	0.043 U	1.3 J	0.34
Total PCBs	mg/kg	0.205	0.085 J	0.109 J	ND	0.01 J	36.3 J	4.24

## Notes:

U - Not present at or above the associated

J - Estimated concentration.

ND - Non-Detect

TABLE 7.1

**PARCEL 201 SOIL SAMPLE ANALYTICAL RESULTS SUMMARY  
GM POWERTRAIN BEDFORD FACILITY  
BEDFORD, INDIANA**

<i>Sample Area:</i>	P201		P201		P201		P201	
<i>Sample Location:</i>	201-21986	201-21987	201-21988	201-21989	201-21990	201-21990	201-21992	201-21992
<i>Sample Date:</i>	4/3/2007	4/3/2007	4/3/2007	4/3/2007	4/3/2007	4/3/2007	4/3/2007	4/4/2007
<i>Sample ID:</i>	S-201-040307-CH-21986	S-201-040307-CH-21987	S-201-040307-CH-21988	S-201-040307-CH-21989	S-201-040307-CH-21990	S-201-040307-CH-21991	S-201-040407-CH-21992	S-201-040407-CH-21992
<i>Depth</i>	(0-0.33)ft	(0-0.33)ft	(0-0.33)ft	(0-0.33)ft	(0-0.33)ft	(0-0.33)ft	(0-0.33)ft (Duplicate)	(0-0.33)ft
<i>Parameters</i>	<i>Units</i>							
<b>PCBs</b>								
Aroclor-1016 (PCB-1016)	mg/kg	4.1 U	2.2 U	0.057 U	0.052 U	0.061 U	0.07 U	0.059 U
Aroclor-1221 (PCB-1221)	mg/kg	4.1 U	2.2 U	0.057 U	0.052 U	0.061 U	0.07 U	0.059 U
Aroclor-1232 (PCB-1232)	mg/kg	4.1 U	2.2 U	0.057 U	0.052 U	0.061 U	0.07 U	0.059 U
Aroclor-1242 (PCB-1242)	mg/kg	4.1 U	2.2 U	0.057 U	0.052 U	0.061 U	0.07 U	0.059 U
Aroclor-1248 (PCB-1248)	mg/kg	110	32	0.73	1.2	0.13 J	0.39 J	0.05 J
Aroclor-1254 (PCB-1254)	mg/kg	4.1 U	2.2 U	0.057 U	0.052 U	0.061 U	0.07 U	0.059 U
Aroclor-1260 (PCB-1260)	mg/kg	5.1	1.6 J	0.07	0.11	0.026 J	0.035 J	0.059 U
Total PCBs	mg/kg	115.1	33.6 J	0.8	1.31	0.156 J	0.425 J	0.05 J

## Notes:

U - Not present at or above the associated

J - Estimated concentration.

ND - Non-Detect

TABLE 7.1

**PARCEL 201 SOIL SAMPLE ANALYTICAL RESULTS SUMMARY  
GM POWERTRAIN BEDFORD FACILITY  
BEDFORD, INDIANA**

<i>Sample Area:</i>	P201	P201	P201	P201	P201	P201	P201
<i>Sample Location:</i>	201-21993	201-21994	201-31002	BH-600	BH-600	BH-600	BH-600
<i>Sample Date:</i>	4/4/2007	4/4/2007	4/5/2007	3/21/2007	3/21/2007	3/21/2007	3/21/2007
<i>Sample ID:</i>	S-201-040407-CH-21993	S-201-040407-CH-21994	S-201-040507-FM-31002	S-201-032107-CH-21865	S-201-032107-CH-21866	S-201-032107-CH-21870	S-201-032107-CH-21871
<i>Depth</i>	(0-0.33)ft	(0-0.33)ft	(0-0.33)ft	(0-0.17)ft	(1-1.17)ft	(5-5.17)ft	(5-5.17)ft (Duplicate)

<i>Parameters</i>	<i>Units</i>							
<i>PCBs</i>								
Aroclor-1016 (PCB-1016)	mg/kg	0.059 U	0.056 U	0.049 U	8.3 U	0.8 U	0.42 U	0.79 U
Aroclor-1221 (PCB-1221)	mg/kg	0.059 U	0.056 U	0.049 U	8.3 U	0.8 U	0.42 U	0.79 U
Aroclor-1232 (PCB-1232)	mg/kg	0.059 U	0.056 U	0.049 U	8.3 U	0.8 U	0.42 U	0.79 U
Aroclor-1242 (PCB-1242)	mg/kg	0.059 U	0.056 U	0.049 U	8.3 U	0.8 U	0.42 U	0.79 U
Aroclor-1248 (PCB-1248)	mg/kg	0.59	0.35	0.049 U	160	13	3.8	8.1
Aroclor-1254 (PCB-1254)	mg/kg	0.059 U	0.056 U	0.049 U	8.3 U	0.8 U	0.42 U	0.79 U
Aroclor-1260 (PCB-1260)	mg/kg	0.036 J	0.028 J	0.049 U	6.8 J	0.68 J	0.83	1.6
Total PCBs	mg/kg	0.626 J	0.378 J	ND	166.8 J	13.68 J	4.63	9.7

## Notes:

U - Not present at or above the associat

J - Estimated concentration.

ND - Non-Detect

TABLE 7.1

**PARCEL 201 SOIL SAMPLE ANALYTICAL RESULTS SUMMARY  
GM POWERTRAIN BEDFORD FACILITY  
BEDFORD, INDIANA**

<i>Sample Area:</i>	<i>P201</i>	<i>P201</i>	<i>P201</i>	<i>P201</i>	<i>P201</i>	<i>P201</i>	<i>P201</i>
<i>Sample Location:</i>	<i>BH-600</i>	<i>BH-601</i>	<i>BH-601</i>	<i>BH-601</i>	<i>BH-602</i>	<i>BH-602</i>	<i>BH-602</i>
<i>Sample Date:</i>	<i>3/21/2007</i>	<i>3/28/2007</i>	<i>3/28/2007</i>	<i>3/28/2007</i>	<i>3/21/2007</i>	<i>3/21/2007</i>	<i>3/21/2007</i>
<i>Sample ID:</i>	<i>S-201-032107-CH-21876</i>	<i>S-201-032807-FM-21957</i>	<i>S-201-032807-FM-21958</i>	<i>S-201-032807-FM-21962</i>	<i>S-201-032107-CH-21883</i>	<i>S-201-032107-CH-21884</i>	<i>S-201-032107-CH-21887</i>
<i>Depth</i>	<i>(10-10.17)ft</i>	<i>(0-0.17)ft</i>	<i>(1-1.17)ft</i>	<i>(4-4.17)ft</i>	<i>(0-0.17)ft</i>	<i>(1-1.17)ft</i>	<i>(4-4.17)ft</i>

<i>Parameters</i>	<i>Units</i>							
<i>PCBs</i>								
Aroclor-1016 (PCB-1016)	mg/kg	0.85 U	0.073 U	0.23 U	0.042 U	0.053 U	0.041 U	0.044 U
Aroclor-1221 (PCB-1221)	mg/kg	0.85 U	0.073 U	0.23 U	0.042 U	0.053 U	0.041 U	0.044 U
Aroclor-1232 (PCB-1232)	mg/kg	0.85 U	0.073 U	0.23 U	0.042 U	0.053 U	0.041 U	0.044 U
Aroclor-1242 (PCB-1242)	mg/kg	0.85 U	0.073 U	0.23 U	0.042 U	0.053 U	0.041 U	0.044 U
Aroclor-1248 (PCB-1248)	mg/kg	23	0.23	2.6	0.016 J	0.67	0.041 U	0.044 U
Aroclor-1254 (PCB-1254)	mg/kg	0.85 U	0.073 U	0.23 U	0.042 U	0.053 U	0.041 U	0.044 U
Aroclor-1260 (PCB-1260)	mg/kg	3.8	0.073 U	0.29	0.042 U	0.06	0.041 U	0.044 U
Total PCBs	mg/kg	26.8	0.23	2.89	0.016 J	0.73	ND	ND

## Notes:

U - Not present at or above the associat

J - Estimated concentration.

ND - Non-Detect

TABLE 7.1

**PARCEL 201 SOIL SAMPLE ANALYTICAL RESULTS SUMMARY  
GM POWERTRAIN BEDFORD FACILITY  
BEDFORD, INDIANA**

<i>Sample Area:</i>	P201		P201		P201		P201	
<i>Sample Location:</i>	BH-603		BH-603		BH-603		BH-604	
<i>Sample Date:</i>	3/27/2007		3/27/2007		3/27/2007		3/27/2007	
<i>Sample ID:</i>	S-201-032707-CH-21942	S-201-032707-CH-21943	S-201-032707-CH-21944	S-201-032707-CH-21948	S-201-032707-CH-21925	S-201-032707-CH-21926	S-201-032707-CH-21930	
<i>Depth</i>	(0-0.17)ft	(0-0.17)ft (Duplicate)	(1-1.17)ft	(5-5.17)ft	(0-0.17)ft	(1-1.17)ft	(5-5.17)ft	
<i>Parameters</i>	<i>Units</i>							
<b>PCBs</b>								
Aroclor-1016 (PCB-1016)	mg/kg	0.042 U	0.045 U	0.042 U	0.042 U	4.3 U	4 U	4.1 U
Aroclor-1221 (PCB-1221)	mg/kg	0.042 U	0.045 U	0.042 U	0.042 U	4.3 U	4 U	4.1 U
Aroclor-1232 (PCB-1232)	mg/kg	0.042 U	0.045 U	0.042 U	0.042 U	4.3 U	4 U	4.1 U
Aroclor-1242 (PCB-1242)	mg/kg	0.042 U	0.045 U	0.042 U	0.042 U	4.3 U	4 U	4.1 U
Aroclor-1248 (PCB-1248)	mg/kg	1.3	0.92	0.029 J	0.016 J	83	42	40
Aroclor-1254 (PCB-1254)	mg/kg	0.042 U	0.045 U	0.042 U	0.042 U	4.3 U	4 U	4.1 U
Aroclor-1260 (PCB-1260)	mg/kg	0.092	0.065	0.042 U	0.042 U	4 J	2.2 J	2.4 J
Total PCBs	mg/kg	1.392	0.985	0.029 J	0.016 J	87 J	44.2 J	42.4 J

## Notes:

U - Not present at or above the associated

J - Estimated concentration.

ND - Non-Detect

TABLE 7.1

**PARCEL 201 SOIL SAMPLE ANALYTICAL RESULTS SUMMARY  
GM POWERTRAIN BEDFORD FACILITY  
BEDFORD, INDIANA**

<i>Sample Area:</i>	P201		P201		P201		P201		P201	
<i>Sample Location:</i>	BH-604		BH-604		BH-605		BH-605		BH-605	
<i>Sample Date:</i>	3/27/2007		3/27/2007		3/28/2007		3/28/2007		3/26/2007	
<i>Sample ID:</i>	S-201-032707-CH-21931		S-201-032707-CH-21934		S-201-032807-FM-21949		S-201-032807-FM-21950		S-201-032607-CH-21913	
<i>Depth</i>	(5-5.17)ft (Duplicate)		(8-8.17)ft		(0-0.17)ft		(1-1.17)ft		(0-0.17)ft	
<i>Parameters</i>	<i>Units</i>									
<b>PCBs</b>										
Aroclor-1016 (PCB-1016)	mg/kg	2 U	0.044 U	0.056 U	0.045 U	0.044 U	0.042 U	0.044 U	0.042 U	0.044 U
Aroclor-1221 (PCB-1221)	mg/kg	2 U	0.044 U	0.056 U	0.045 U	0.044 U	0.042 U	0.044 U	0.042 U	0.044 U
Aroclor-1232 (PCB-1232)	mg/kg	2 U	0.044 U	0.056 U	0.045 U	0.044 U	0.042 U	0.044 U	0.042 U	0.044 U
Aroclor-1242 (PCB-1242)	mg/kg	2 U	0.044 U	0.056 U	0.045 U	0.044 U	0.042 U	0.044 U	0.042 U	0.044 U
Aroclor-1248 (PCB-1248)	mg/kg	19	0.21	2	0.057	0.015 J	0.042 U	0.044 U	0.042 U	0.035 J
Aroclor-1254 (PCB-1254)	mg/kg	2 U	0.044 U	0.056 U	0.045 U	0.044 U	0.042 U	0.044 U	0.042 U	0.044 U
Aroclor-1260 (PCB-1260)	mg/kg	1.6 J	0.025 J	0.21	0.045 U	0.044 U	0.042 U	0.044 U	0.042 U	0.044 U
Total PCBs	mg/kg	20.6 J	0.235 J	2.21	0.057	0.015 J	ND	0.015 J	ND	0.035 J

## Notes:

U - Not present at or above the associated

J - Estimated concentration.

ND - Non-Detect



TABLE 7.1

**PARCEL 201 SOIL SAMPLE ANALYTICAL RESULTS SUMMARY  
GM POWERTRAIN BEDFORD FACILITY  
BEDFORD, INDIANA**

<i>Sample Area:</i>	<i>P201</i>	<i>P201</i>	<i>P201</i>	<i>P201</i>	<i>P201</i>	<i>P201</i>	<i>P201</i>	
<i>Sample Location:</i>	<i>BH-606</i>	<i>BH-606</i>	<i>BH-606</i>	<i>BH-606</i>	<i>BH-607</i>	<i>BH-607</i>	<i>BH-607</i>	
<i>Sample Date:</i>	<i>3/26/2007</i>	<i>3/26/2007</i>	<i>3/26/2007</i>	<i>3/26/2007</i>	<i>3/26/2007</i>	<i>3/26/2007</i>	<i>3/26/2007</i>	
<i>Sample ID:</i>	<i>S-201-032607-CH-21914</i>	<i>S-201-032607-CH-21918</i>	<i>S-201-032607-CH-21923</i>	<i>S-201-032607-CH-21924</i>	<i>S-201-032607-CH-21903</i>	<i>S-201-032607-CH-21904</i>	<i>S-201-032607-CH-21907</i>	
<i>Depth</i>	<i>(1-1.17)ft</i>	<i>(5-5.17)ft</i>	<i>(9-9.17)ft</i>	<i>(10-10.17)ft</i>	<i>(0-0.17)ft</i>	<i>(1-1.17)ft</i>	<i>(4-4.17)ft</i>	
<i>Parameters</i>	<i>Units</i>							
<i>PCBs</i>								
Aroclor-1016 (PCB-1016)	mg/kg	0.044 U	0.04 U	0.046 U	0.043 U	0.45 U	2.2 U	0.036 U
Aroclor-1221 (PCB-1221)	mg/kg	0.044 U	0.04 U	0.046 U	0.043 U	0.45 U	2.2 U	0.036 U
Aroclor-1232 (PCB-1232)	mg/kg	0.044 U	0.04 U	0.046 U	0.043 U	0.45 U	2.2 U	0.036 U
Aroclor-1242 (PCB-1242)	mg/kg	0.044 U	0.04 U	0.046 U	0.043 U	0.45 U	2.2 U	0.036 U
Aroclor-1248 (PCB-1248)	mg/kg	0.044 U	0.04 U	0.011 J	0.043 U	6.2	21	1
Aroclor-1254 (PCB-1254)	mg/kg	0.044 U	0.04 U	0.046 U	0.043 U	0.45 U	2.2 U	0.036 U
Aroclor-1260 (PCB-1260)	mg/kg	0.044 U	0.04 U	0.046 U	0.043 U	0.34 J	0.99 J	0.067
Total PCBs	mg/kg	ND	ND	0.011 J	ND	6.54 J	21.99 J	1.067

## Notes:

U - Not present at or above the associat

J - Estimated concentration.

ND - Non-Detect

TABLE 7.1

**PARCEL 201 SOIL SAMPLE ANALYTICAL RESULTS SUMMARY  
GM POWERTRAIN BEDFORD FACILITY  
BEDFORD, INDIANA**

<i>Sample Area:</i>	P201		P201		P201		P201	
<i>Sample Location:</i>	BH-607		BH-608		BH-608		BH-609	
<i>Sample Date:</i>	3/26/2007		3/21/2007		3/21/2007		3/27/2007	
<i>Sample ID:</i>	S-201-032607-CH-21912		S-201-032107-CH-21877		S-201-032107-CH-21882		S-201-032707-CH-21936	
<i>Depth</i>	(8-8.17)ft		(0-0.17)ft		(1-1.17)ft		(4-4.17)ft	
<i>Parameters</i>	<i>Units</i>							
<b>PCBs</b>								
Aroclor-1016 (PCB-1016)	mg/kg	0.043 U	0.046 U	0.043 U	0.042 U	0.048 U	0.044 U	0.043 U
Aroclor-1221 (PCB-1221)	mg/kg	0.043 U	0.046 U	0.043 U	0.042 U	0.048 U	0.044 U	0.043 U
Aroclor-1232 (PCB-1232)	mg/kg	0.043 U	0.046 U	0.043 U	0.042 U	0.048 U	0.044 U	0.043 U
Aroclor-1242 (PCB-1242)	mg/kg	0.043 U	0.046 U	0.043 U	0.042 U	0.048 U	0.044 U	0.043 U
Aroclor-1248 (PCB-1248)	mg/kg	0.027 J	0.063	0.016 J	0.042 U	0.41	0.44	0.56
Aroclor-1254 (PCB-1254)	mg/kg	0.043 U	0.046 U	0.043 U	0.042 U	0.048 U	0.044 U	0.043 U
Aroclor-1260 (PCB-1260)	mg/kg	0.043 U	0.046 U	0.043 U	0.042 U	0.062	0.039 J	0.036 J
Total PCBs	mg/kg	0.027 J	0.063	0.016 J	ND	0.472	0.479 J	0.596 J

## Notes:

U - Not present at or above the associated

J - Estimated concentration.

ND - Non-Detect

TABLE 7.1

**PARCEL 201 SOIL SAMPLE ANALYTICAL RESULTS SUMMARY  
GM POWERTRAIN BEDFORD FACILITY  
BEDFORD, INDIANA**

<i>Sample Area:</i>	P201		P201		P201		P201		P201	
<i>Sample Location:</i>	BH-609		BH-610		BH-610		BH-611		BH-611	
<i>Sample Date:</i>	3/27/2007		3/28/2007		3/28/2007		4/5/2007		4/13/2007	
<i>Sample ID:</i>	S-201-032707-CH-21941		S-201-032807-FM-21963		S-201-032807-FM-21964		S-201-032807-FM-21967		S-201-040507-FM-31000	
<i>Depth</i>	(6-6.17)ft		(0-0.17)ft		(1-1.17)ft		(4-4.17)ft		(0-0.33)ft (Duplicate)	
<i>Parameters</i>	<i>Units</i>									
<b>PCBs</b>										
Aroclor-1016 (PCB-1016)	mg/kg	0.048 U	0.061 U	0.045 U	0.043 U	0.9 U	0.83 U	4.1 U		
Aroclor-1221 (PCB-1221)	mg/kg	0.048 U	0.061 U	0.045 U	0.043 U	0.9 U	0.83 U	4.1 U		
Aroclor-1232 (PCB-1232)	mg/kg	0.048 U	0.061 U	0.045 U	0.043 U	0.9 U	0.83 U	4.1 U		
Aroclor-1242 (PCB-1242)	mg/kg	0.048 U	0.061 U	0.045 U	0.043 U	0.9 U	0.83 U	4.1 U		
Aroclor-1248 (PCB-1248)	mg/kg	1.6	0.31	0.92	0.43	14	19	50		
Aroclor-1254 (PCB-1254)	mg/kg	0.048 U	0.061 U	0.045 U	0.043 U	0.9 U	0.83 U	4.1 U		
Aroclor-1260 (PCB-1260)	mg/kg	0.071	0.073	0.062	0.016 J	0.77 J	0.76 J	1.3 J		
Total PCBs	mg/kg	1.671	0.383	0.982	0.446 J	14.77 J	19.76 J	51.3 J		

## Notes:

U - Not present at or above the associat

J - Estimated concentration.

ND - Non-Detect

TABLE 7.1

**PARCEL 201 SOIL SAMPLE ANALYTICAL RESULTS SUMMARY  
GM POWERTRAIN BEDFORD FACILITY  
BEDFORD, INDIANA**

<i>Sample Area:</i>	<i>P201</i>	<i>P201</i>	<i>P201</i>	<i>P201</i>	<i>P201</i>	<i>P201</i>	<i>P201</i>	
<i>Sample Location:</i>	<i>BH-611</i>	<i>BH-611</i>	<i>BH-612</i>	<i>BH-612</i>	<i>BH-612</i>	<i>BH-612</i>	<i>BH-613</i>	
<i>Sample Date:</i>	<i>4/13/2007</i>	<i>4/13/2007</i>	<i>4/13/2007</i>	<i>4/13/2007</i>	<i>4/13/2007</i>	<i>4/13/2007</i>	<i>4/5/2007</i>	
<i>Sample ID:</i>	<i>S-201-041307-JL-2018</i>	<i>S-201-041307-JL-2019</i>	<i>S-201-041307-JL-2013</i>	<i>S-201-041307-JL-2014</i>	<i>S-201-041307-JL-2015</i>	<i>S-201-041307-JL-2016</i>	<i>S-201-040507-FM-31003</i>	
<i>Depth</i>	<i>(10-11)ft</i>	<i>(20-22)ft</i>	<i>(0-0.6)ft</i>	<i>(1-2)ft</i>	<i>(12-13)ft</i>	<i>(21-22)ft</i>	<i>(0-0.33)ft</i>	
<i>Parameters</i>	<i>Units</i>							
<i>PCBs</i>								
Aroclor-1016 (PCB-1016)	mg/kg	0.039 U	0.042 U	4 U	4.1 U	0.04 U	0.041 U	0.039 U
Aroclor-1221 (PCB-1221)	mg/kg	0.039 U	0.042 U	4 U	4.1 U	0.04 U	0.041 U	0.039 U
Aroclor-1232 (PCB-1232)	mg/kg	0.039 U	0.042 U	4 U	4.1 U	0.04 U	0.041 U	0.039 U
Aroclor-1242 (PCB-1242)	mg/kg	0.039 U	0.042 U	4 U	4.1 U	0.04 U	0.041 U	0.039 U
Aroclor-1248 (PCB-1248)	mg/kg	0.02 J	0.042 U	35	83	0.068	0.041 U	0.16
Aroclor-1254 (PCB-1254)	mg/kg	0.039 U	0.042 U	4 U	4.1 U	0.04 U	0.041 U	0.039 U
Aroclor-1260 (PCB-1260)	mg/kg	0.039 U	0.042 U	1.1 J	2.9 J	0.035 J	0.041 U	0.016 J
Total PCBs	mg/kg	0.02 J	ND	36.1 J	85.9 J	0.103 J	ND	0.176 J

## Notes:

U - Not present at or above the associated

J - Estimated concentration.

ND - Non-Detect

TABLE 7.1

**PARCEL 201 SOIL SAMPLE ANALYTICAL RESULTS SUMMARY  
GM POWERTRAIN BEDFORD FACILITY  
BEDFORD, INDIANA**

<i>Sample Area:</i>	<i>P201</i>	<i>P201</i>	<i>P201</i>
<i>Sample Location:</i>	<i>BH-613</i>	<i>BH-613</i>	<i>BH-613</i>
<i>Sample Date:</i>	<i>4/13/2007</i>	<i>4/13/2007</i>	<i>4/13/2007</i>
<i>Sample ID:</i>	<i>S-201-041307-JL-2010</i>	<i>S-201-041307-JL-2011</i>	<i>S-201-041307-JL-2012</i>
<i>Depth</i>	<i>(1-2)ft</i>	<i>(11-12)ft</i>	<i>(21-22)ft</i>

<i>Parameters</i>	<i>Units</i>			
<i>PCBs</i>				
Aroclor-1016 (PCB-1016)	mg/kg	0.41 U	0.043 U	0.041 U
Aroclor-1221 (PCB-1221)	mg/kg	0.41 U	0.043 U	0.041 U
Aroclor-1232 (PCB-1232)	mg/kg	0.41 U	0.043 U	0.041 U
Aroclor-1242 (PCB-1242)	mg/kg	0.41 U	0.043 U	0.041 U
Aroclor-1248 (PCB-1248)	mg/kg	5.1	0.081	0.041 U
Aroclor-1254 (PCB-1254)	mg/kg	0.41 U	0.043 U	0.041 U
Aroclor-1260 (PCB-1260)	mg/kg	0.15 J	0.043 U	0.041 U
Total PCBs	mg/kg	5.25 J	0.081	ND

## Notes:

U - Not present at or above the associat

J - Estimated concentration.

ND - Non-Detect

APPENDIX A

CONSTRUCTION MEETING MINUTES



## MEETING MINUTES

Reference No. 13968

PROJECT: GM Powertrain Removal Action Project

OWNER: General Motors CONTRACT NO.: 13968(41, 89)

RE: Construction Meeting

LOCATION: Bedford, Indiana DATE: April 03, 2007 TIME: 01:00 p.m.

Participants:

Katie Kamm; CRA	Dan Nelson; CRA	Edgar Longstreet; ENTACT
Rick Hoekstra; CRA	Earney Funderburg; ENTACT	John Cooper; ENTACT
Terri Stewart; CRA	Ed Long; ENTACT	Heather Alcore; ENTACT
Yelena Moskvina; CRA		

Distribution:

Cheryl Hiatt; GM	Ed Peterson; GM	Glenn Turchan; CRA
Jim McGuigan; CRA	Jeff Daniel; CRA	Katie Kamm; CRA
Terri Channing; CRA	Mary Kelly; CRA	Peter Ramanauskas; USEPA
Brad Stimple; USEPA	Jerry O'Callaghan; IDEM	Jean Greensley; USEPA

<i>Item</i>	<i>Description</i>	<i>Action By</i>
<b>1.0</b>	<b>HEALTH AND SAFETY</b>	
1.1	ENTACT continues to perform air monitoring in East Plant work areas.	ENTACT
1.2	Contractors were reminded to wear appropriate PPE and use decon facilities when exiting the East Plant work areas.	--
<b>2.0</b>	<b>REQUEST FOR INFORMATION</b>	
2.1	None at this time.	
<b>3.0</b>	<b>GENERAL WORK ACTIVITIES</b>	
3.1	ENTACT and CRA reviewed "Active", "Inactive", and "Non-Billable" workday tracking logs.	CRA
3.2	Signage was placed at the East Parking lot entryways.	ENTACT
3.3	ENTACT will not cover new or revised structures with material prior to CRA approval and all required surveys are complete.	ENTACT
3.4	ENTACT will assist STL (1-2 times per month) with the disposal on spent testing soil into the vault.	ENTACT
<b>4.0</b>	<b>GRADING AREAS # 1, 2, 3 AND 4, FILL AREAS (FA-1A &amp; FA-1B)</b>	
4.1	ENTACT continues to perform necessary repairs to all grading and fill areas as appropriate.	ENTACT
4.2	ENTACT continues to inspect GA-1 berm (area of erosion) which was previously repaired.	ENTACT



<i>Item</i>	<i>Description</i>	<i>Action By</i>
4.3	HRC has replaced and covered the berm on GA-3, water management has been returned to ENTACT's control as of 04-03-07	ENTACT
4.4	All surface water has been re-routed out of collection sump "C" and "H" to WW#3.	ENTACT
<b>5.0</b>	<b>VAULT AREA AOI7</b>	
5.1	No new activities. SES continues to perform water management and site maintenance work as appropriate.	SES
5.2	Sevenson will begin construction of a berm along the north end of the vault on 04-10-07 diverting all water away from the vault liner keys.	SES
<b>6.0</b>	<b>SURFACE &amp; STORM WATER CONTROLS</b>	
6.1	Water management activities and site maintenance work was conducted by both contractors, as appropriate.	SES/ENTACT
6.2	ENTACT continues to obtain CRA approval prior to de-watering sumps.	ENTACT
6.3	SES and ENTACT continue to coordinate efforts in establishing storm water control piping from the East Plant to the modutanks.	SES/ENTACT
6.4	ENTACT will inspect all sediment controls daily.	ENTACT
6.5	ENTACT completed the placement of additional sediment at storm drain manhole in NE corner of the pond on 03-30-07.	ENTACT
6.6	ENTACT placed additional liner south of FA-1A sump as requested on 03-27-07.	ENTACT
6.7	CRA expressed to ENTACT the importance to cover/tarp all disturbed areas immediately to prevent sediment flow to the creek. ENTACT recognizes CRA's concerns and will implement additional measures to correct.	ENTACT
<b>7.0</b>	<b>CAP/FILL PLACEMENT</b>	
7.1	ENTACT continues to receive <50-ppm material from the downstream parcels and place the material in compacted lifts. ENTACT continues to cover the berm and fill placement area with tarps daily.	ENTACT
7.2	ENTACT was not able to receive material for full day on 03-28-07 due to severe storms (Non-Billable Day) and delayed start (9:50 AM) on 03-31-07 due to rain (Active Day).	ENTACT
7.3	The fill placement area berm perimeters continue to be expanded as necessary, ENTACT is currently constructing a new haul road and dump ramp as well as extending the berm northeast of AOI-4 for fill placement.	ENTACT
<b>8.0</b>	<b>SITE STRUCTURES</b>	
8.1	CRA (Steve Davis) and PSI were on site for concrete/rebar inspections for ENTACT's subcontractor Dave O'Mara on 03-29-07, the west wall of the concrete headwall structure on the east end of Outfall 003 was approved and concrete breaks are pending.	ENTACT





Item	Description	Action By
8.2	On 04-02-07 ENTACT's subcontractor Dave O'Mara constructed the top of the concrete headwall structure on the east end of Outfall 003. The rebar was approved and ENTACT was advised the concrete did not meet the required air entrainment of 5-7% for freeze thaw requirements. ENTACT chose to use the concrete and advised they would protect the concrete with blankets during the forecasted freezing temperatures. Outfall 003 will not be covered with material pending acceptance of all concrete breaks and CRA approval.	ENTACT
8.3	Spring "I" gravity drain repairs were completed on 03-30-07.	ENTACT
8.4	SES will complete the sediment removal from Collection Systems "H" and "C, on 04-03-07. Once complete, ENTACT will cover both sump structures with steal plates to protect and seal.	SES
8.5	SES exposed Corehole 20. RDNP will repair on 04-05-07.	SES/RDNP
8.6	The concrete bases of all removed fence will be placed into fill area. Above ground portions of the fence will be disposed with general site debris.	ENTACT
8.7	The existing 24" HDPE pipe under GA-2 was broken at the north end while ENTACT attempted to position the pipe for welding on additional pipe extensions. ENTACT will repair the pipe.	ENTACT
9.0	<b>WORK HOURS</b>	
9.1	ENTACT is working Monday through Saturday 7:00 a.m. to 5:30 p.m.	ENTACT
9.2	ENTACT's water management night crew hours are 7:00 p.m. to 6:00 a.m.	ENTACT
9.3	SES has reduced their crews to water management and night crews for vault maintenance, work crews are available as needed.	SES
10.0	<b>SUB-CONTRACTORS ON-SITE</b>	
10.1	PSI - CRA concrete testing	CRA
10.2	Dave O'Mara - ENTACT Outfall 003 headwall construction	ENTACT
10.3	RDNP - CRA Corehole repair	CRA
10.4	Rain for Rent - ENTACT HDPE pipe welding	ENTACT
10.5	BRG - ENTACT surveyors	ENTACT

Attachments: \_\_\_\_\_

Prepared By: Terri Stewart Date Issued: June 16, 2007

This confirms and records CRA's interpretation of the discussions that occurred and our understanding reached during this meeting. Unless notified in writing within 3 days of the date issued, we will assume that the following interpretation or description is complete and accurate.



## MEETING MINUTES

Reference No. 13968

PROJECT: GM Powertrain Removal Action Project  
 OWNER: General Motors CONTRACT NO.: 13968(41, 89)  
 RE: Construction Meeting  
 LOCATION: Bedford, Indiana DATE: April 10, 2007 TIME: 01:00 p.m.

**Participants:**

Katie Kamm; CRA	Earney Funderburg; ENTACT	Doug Reynolds; SES
Terri Stewart; CRA	Sebastian Bahr; ENTACT	Randy Campbell; SES
Yelena Moskvina; CRA	Edgar Longstreet; ENTACT	Dan Sekanovich; SES
Dan Nelson; CRA	Phil Harkins; ENTACT	Janelle Becher; SES
Mike Staub; ENTACT	John Cooper; ENTACT	Chris Bement; SES

**Distribution:**

Cheryl Hiatt; GM	Ed Peterson; GM	Glenn Turchan; CRA
Jim McGuigan; CRA	Jeff Daniel; CRA	Katie Kamm; CRA
Terri Channing; CRA	Mary Kelly; CRA	Peter Ramanauskas; USEPA
Brad Stimple; USEPA	Jerry O'Callaghan; IDEM	Jean Greensley; USEPA

<i>Item</i>	<i>Description</i>	<i>Action By</i>
<b>1.0</b>	<b>HEALTH AND SAFETY</b>	
1.1	ENTACT continues to perform air monitoring in all work areas.	ENTACT
1.2	Contractors were reminded to properly wear PPE (i.e. no baseball caps under hardhat, sweatshirts outside of tyvek, etc.)	SES/ENTACT
1.3	Site workers have been reminded that the site radios are for project related communications.	ENTACT
<b>2.0</b>	<b>REQUEST FOR INFORMATION</b>	
2.1	None at this time.	
<b>3.0</b>	<b>GENERAL WORK ACTIVITIES</b>	
3.1	ENTACT and CRA reviewed "Active", "Inactive", and "Non-Billable" workday tracking logs.	CRA
3.2	ENTACT completed construction of the north dump ramp to the fill areas on 04-10-07; trucks will be diverted to this ramp starting on 04-12-07.	ENTACT
3.4	ENTACT was reminded that watering of roadways is for dust control and not to wash roads. There have been community complaints regarding the "flooding" of the streets.	ENTACT
3.5	Material removed from collection sumps "C" and "H" is <50-ppm and can be placed into the fill area.	ENTACT
3.6	ENTACT will clean the entrance to the east plant area to remove clean clay remnants from the vault berm construction work.	ENTACT



<i>Item</i>	<i>Description</i>	<i>Action By</i>
<b>4.0</b>	<b>GRADING AREAS # 1, 2, 3 AND 4, FILL AREAS (FA-1A &amp; FA-1B)</b>	
4.1	Water management activities and site maintenance work was conducted as appropriate.	ENTACT
<b>5.0</b>	<b>VAULT AREA AOI7</b>	
5.1	SES continues to perform water management and site maintenance work as appropriate.	SES
5.2	Sevenson began construction of the diversion berm along the north end of the vault on 04-10-07 (diverting surface water away from the vault liner key).	SES
<b>6.0</b>	<b>SURFACE &amp; STORM WATER CONTROLS</b>	
6.1	ENTACT will put into operation additional measures to ensure remediation waters are controlled.	ENTACT
6.2	CRA expressed to ENTACT the importance to cover/tarp all disturbed areas immediately to prevent sediment flow to the creek; ENTACT recognizes CRA's concerns and will implement additional measures to correct.	ENTACT
6.3	ENTACT continues to maintain a berm/sump enclosing the fill placement area to contain all surface water. The berm and compacted material are covered daily with tarps.	SES/ENTACT
6.4	ENTACT will inspect sediment controls daily.	ENTACT
6.5	SES and ENTACT continue to coordinate efforts in establishing storm water control piping from the East Plant to the modutanks.	SES/ENTACT
6.6	ENTACT will obtain CRA authorization prior to pumping water to SES modutanks or WW#3.	ENTACT
<b>7.0</b>	<b>CAP/FILL PLACEMENT</b>	
7.1	ENTACT continues to receive <50-ppm material from the downstream parcels and place the material in compacted lifts.	ENTACT
7.2	ENTACT did not work on 04-07-07 in lieu of the Easter weekend.	ENTACT
7.3	ENTACT will begin moving material from FA-1A on 04-12-07.	ENTACT
<b>8.0</b>	<b>SITE STRUCTURES</b>	
8.1	O'Mara removed the concrete forms on outfall 003 on 04-06-07. Concrete breaks are pending.	ENTACT
8.2	The 24" pipe (clean storm water by-pass) welding work was completed on 04-06-07. ENTACT will grade maintaining a 4-6% slope to the Pond#5 headwall structure.	ENTACT
8.3	Sediment removal from Collection Systems "H" and "C" was completed on 04-03-07. Steel covers were placed on both sump structures on 04-09-07.	SES/ENTACT
<b>9.0</b>	<b>WORK HOURS</b>	
9.1	ENTACT is working Monday through Saturday 7:00 a.m. to 5:30 p.m.	ENTACT
9.2	ENTACT's water management night crew hours are 7:00 p.m. to 6:00 a.m.	ENTACT
9.3	SES has reduced their crews to water management and night crews for vault maintenance, work crews are available as needed.	SES



<i>Item</i>	<i>Description</i>	<i>Action By</i>
<b>10.0</b>	<b>SUB-CONTRACTORS ON-SITE</b>	
10.1	Dave O'Mara – ENTACT Outfall 003 headwall construction	ENTACT
10.2	Rain for Rent – ENTACT HDPE pipe welding	ENTACT
10.3	ISCO – ENTACT pipe welding	ENTACT

Attachments: \_\_\_\_\_

Prepared By:  Terri Stewart \_\_\_\_\_ Date Issued: June 16, 2007

This confirms and records CRA's interpretation of the discussions that occurred and our understanding reached during this meeting. Unless notified in writing within 3 days of the date issued, we will assume that the following interpretation or description is complete and accurate.



## MEETING MINUTES

Reference No. 13968

PROJECT: GM Powertrain Removal Action Project  
 OWNER: General Motors CONTRACT NO.: 13968(41, 89)  
 RE: Construction Meeting  
 LOCATION: Bedford, Indiana DATE: April 17, 2007 TIME: 01:00 p.m.

Participants:

Terri Stewart; CRA	Ed Long; ENTACT	John Cooper; ENTACT
Dan Nelson; CRA	Sebastian Bahr; ENTACT	Dan Sekanovich; SES
Earney Funderburg; ENTACT	Edgar Longstreet; ENTACT	Randy Campbell; SES

Distribution:

Cheryl Hiatt; GM	Ed Peterson; GM	Glenn Turchan; CRA
Jim McGuigan; CRA	Jeff Daniel; CRA	Katie Kamm; CRA
Terri Channing; CRA	Mary Kelly; CRA	Peter Ramanauskas; USEPA
Brad Stimple; USEPA	Jerry O'Callaghan; IDEM	Jean Greensley; USEPA

Item	Description	Action By
<b>1.0</b>	<b>HEALTH AND SAFETY</b>	
1.1	ENTACT continues to perform dust monitoring in East Plant work areas.	ENTACT
1.2	Contractors were reminded personnel are required to wear the appropriate PPE (to include tyvek) for their work area.	ENTACT
1.3	ENTACT was reminded that vehicles are not to be left running without an operator at the wheel. ENTACT will initiate additional measures to enforce this with their workers.	ENTACT
1.4	Site workers have been reminded that the site radios are for project related communications.	ENTACT
<b>2.0</b>	<b>REQUEST FOR INFORMATION</b>	
2.1	ENTACT was asked to submit a cost estimate to abandon the Outfall 003 structure and associated piping.	ENTACT
<b>3.0</b>	<b>GENERAL WORK ACTIVITIES</b>	
3.1	ENTACT and CRA reviewed "Active", "Inactive", and "Non-Billable" workday tracking logs.	CRA
3.2	ENTACT is in the process of repairing front jets on water truck.	ENTACT
3.3	ENTACT placed "Non Potable Water" signage on water truck.	ENTACT



Item	Description	Action By
3.4	RDNP drillers began corehole abandonment work on 04-17-07. The drillers will abandon CH's 28, 28A, 29, 29A, 30, 31, and 33.	CRA/RDNP
4.0	<b>GRADING AREAS # 1, 2, 3 AND 4, FILL AREAS (FA-1A &amp; FA-1B)</b>	
4.1	Water management activities and site maintenance work was conducted as appropriate.	ENTACT
4.2	ENTACT was reminded to tarping repairs promptly following wind and rain events.	ENTACT
5.0	<b>VAULT AREA AOI7</b>	
5.1	SES continues to perform water management and site maintenance work as appropriate.	SES
5.2	Sevenson continues the vault diversion berm placement. The placement area was extended to include the entire west side of the vault and a small portion along the south side of the vault.	SES
6.0	<b>SURFACE &amp; STORM WATER CONTROLS</b>	
6.1	ENTACT continues to maintain a berm/sump enclosing the fill placement area to contain surface water. The berm and compacted material are covered daily with tarps.	ENTACT
6.2	SES and ENTACT continue to coordinate efforts in establishing storm water control piping from the East Plant to the modutanks.	ENTACT
6.3	On 04-12-07 ENTACT addressed site workers during a "Stop Work" of the importance of pump, hose, and sediment controls, daily inspections, and the need to cover/tarp disturbed areas promptly. This information will be incorporated into the site orientation for all new employees.	SES/ENTACT
6.4	ENTACT continues to obtain CRA authorization prior to pumping water to SES modu tanks or WW#3.	ENTACT
6.5	ENTACT's site superintendents will ensure hoses and pumps are in place and secure at the beginning and end of the workday.	ENTACT
6.6	ENTACT is installing an above ground culvert crossing at the SE corner of the WTP building to protect the 6" lay flat hose from FA-1A to WW#3.	ENTACT
7.0	<b>CAP/FILL PLACEMENT</b>	
7.1	ENTACT continues to receive <50-ppm material from the downstream parcels and place the material in compacted lifts.	ENTACT
7.2	No material was hauled to the East Plant from the downstream parcels on 04-11-07 and 04-14-07 due to rain.	ENTACT
7.3	ENTACT began relocating material from FA-1A (i.e. the east parking lot) to the fill area north of GA-2 on 04-13-07.	ENTACT
7.4	On 04-17-07 ENTACT extended their containment berm north of AOI-10 to increase fill space. The tarped berm will remain in place for the remainder of fill placement in this area.	ENTACT



<i>Item</i>	<i>Description</i>	<i>Action By</i>
<b>8.0</b>	<b>SITE STRUCTURES</b>	
8.1	ENTACT was advised the 14-day concrete break for Outfall 003's top structure was acceptable. The 28-day breaks are pending.	ENTACT
8.2	ENTACT completed the 24" pipe placement on 04-13-07, CRA and BRG surveyed and CRA advised on 04-16-07 as approved.	ENTACT
<b>9.0</b>	<b>WORK HOURS</b>	
9.1	ENTACT is working Monday through Saturday 7:00 a.m. to 5:30 p.m.	ENTACT
9.2	ENTACT's water management night crew hours are 7:00 p.m. to 6:00 a.m.	ENTACT
9.3	SES has reduced their crews to water management and night crews for vault maintenance, work crews are available as needed.	SES
<b>10.0</b>	<b>SUB-CONTRACTORS ON-SITE</b>	
	No subcontractors on-site.	

Attachments: \_\_\_\_\_

Prepared By:  Terri Stewart Date Issued: June 16, 2007

This confirms and records CRA's interpretation of the discussions that occurred and our understanding reached during this meeting. Unless notified in writing within 3 days of the date issued, we will assume that the following interpretation or description is complete and accurate.



## MEETING MINUTES

Reference No. 13968

PROJECT: GM Powertrain Removal Action Project

OWNER: General Motors CONTRACT NO.: 13968(41, 89)

RE: Construction Meeting

LOCATION: Bedford, Indiana DATE: May 1, 2007 TIME: 1:00 p.m.

**Participants:**

Terri Stewart; CRA	Earney Funderburg; ENTACT	Dan Sekanovich; SES
Yelena Moskvina; CRA	Tim Hiiltune; ENTACT	Randy Campbell; SES
Dan Nelson; CRA	Robin Compton; ENTACT	

**Distribution:**

Cheryl Hiatt; GM	Ed Peterson; GM	Glenn Turchan; CRA
Jim McGuigan; CRA	Jeff Daniel; CRA	Katie Kamm; CRA
Terri Channing; CRA	Mary Kelly; CRA	Peter Ramanauskas; USEPA
Brad Stimple; USEPA	Jerry O'Callaghan; IDEM	Jean Greensley; USEPA

<i>Item</i>	<i>Description</i>	<i>Action By</i>
<b>1.0</b>	<b>HEALTH AND SAFETY</b>	
1.1	ENTACT continues to perform dust monitoring in East Plant work areas.	ENTACT
1.2	ENTACT will initiate additional measures to enforce PPE requirements.	ENTACT
1.3	Contractors will re-address speed limit concerns with all subcontractors and site personnel.	ENTACT
<b>2.0</b>	<b>REQUEST FOR INFORMATION</b>	
2.1	ENTACT provided a cost estimate for the abandonment of the Outfall 003 structure. CRA requested a revised cost estimate utilizing a flowable fill replacing the concrete. ENTACT was later requested to provide a cost backup for their subcontractor Dave O'Mara Construction by 05-04-07.	ENTACT
<b>3.0</b>	<b>GENERAL WORK ACTIVITIES</b>	
3.1	CRA reviewed "Active", "Inactive", and "Non-Billable" workday tracking log. ENTACT accepted.	CRA
3.2	ENTACT will notify CRA of ENTACT's chain of command during management's absence.	ENTACT
3.3	ENTACT's new East Plant QA/QC, Barbara Longstreet, will arrive on site on 05-02-07.	ENTACT
<b>4.0</b>	<b>GRADING AREAS # 1, 2, 3 AND 4, FILL AREAS (FA-1A &amp; FA-1B)</b>	
4.1	Water management activities and site maintenance work was conducted as appropriate.	ENTACT





<i>Item</i>	<i>Description</i>	<i>Action By</i>
4.2	ENTACT continues to confirm all required tarping is in place and secured prior to leaving at the end of the day. CRA continues to verify as acceptable.	ENTACT
<b>5.0</b>	<b>VAULT AREA AOI7</b>	
5.1	SES continues to perform water management and site maintenance work as appropriate.	SES
5.2	SES was requested to re-mulch the vault surface by 05-04-07, weather permitting.	SES
<b>6.0</b>	<b>SURFACE &amp; STORM WATER CONTROLS</b>	
6.1	ENTACT continues to maintain a berm/sump enclosing the fill placement area to contain all surface water. The berm and compacted material are covered daily with tarps.	ENTACT
6.2	SES and ENTACT continue to coordinate efforts in establishing storm water control piping from the East Plant to the modutanks.	ENTACT/SES
6.3	ENTACT continues to obtain CRA authorization prior to pumping water to SES modu tanks or WW#3.	ENTACT
6.4	SES has relocated the vault surface and sump effluent pipe to WW#3 on 04-27-07.	SES
<b>7.0</b>	<b>CAP/FILL PLACEMENT</b>	
7.1	ENTACT continues to receive <50-ppm material from the downstream parcels and place the material in compacted lifts. ENTACT continues to cover the berm and fill placement area with tarps daily.	ENTACT
7.2	ENTACT intends to use mulch (con-cover) instead of tarps pending CRA approval.	ENTACT
7.3	CRA will provide ENTACT with the analytical information for the clean clay material received from Borrow Source 39-1.	CRA
<b>8.0</b>	<b>SITE STRUCTURES</b>	
8.1	ENTACT began installation of the Treated Water-Monitoring Chamber on 04-27-07 with an anticipated completion date of 05-04-07.	ENTACT
8.2	The proctor testing done on 05-01-07 by PSI for the #53 stone compaction in the construction of the Treated Water-Monitoring Chamber was approved.	ENTACT
8.3	ENTACT will begin installation of the north and south 24" pipe concrete headwalls on 05-02-07.	ENTACT
8.4	The electrical pull through box located north of GA-2 was buried under placement fill on 04-27-07.	ENTACT
8.5	SES completed cleaning out Collection Sump "A" on 04-25-07.	SES
8.6	Corehole-22 will remain in its current condition until work resumes in that area at which time ENTACT will weld on an extension to maintain a final pipe elevation of 2.5 feet above final grade.	ENTACT
8.7	ENTACT noted the steel plate cover will be placed over Collection Sump "A" by 05-05-07 preventing future access.	ENTACT
<b>9.0</b>	<b>WORK HOURS</b>	
9.1	ENTACT is working Monday through Saturday 7:00 a.m. to 5:30 p.m.	ENTACT



<i>Item</i>	<i>Description</i>	<i>Action By</i>
9.2	ENTACT's water management night crew hours are 7:00 p.m. to 6:00 a.m. SES is currently working M-T 10-hour days; water management crews on site as needed for storm water control..	ENTACT SES
9.3		
<b>10.0</b>	<b>SUB-CONTRACTORS ON-SITE</b>	
10.1	PSI - ENTACT compaction testing on 05-01-07	ENTACT
10.2	ENTACT advised Dave O'Mara Construction will be on-site on 05-02-07 to form concrete headwalls.	ENTACT

Attachments: \_\_\_\_\_

Prepared By:  Terri Stewart Date Issued: June 16, 2007

This confirms and records CRA's interpretation of the discussions that occurred and our understanding reached during this meeting. Unless notified in writing within 3 days of the date issued, we will assume that the following interpretation or description is complete and accurate.



## MEETING MINUTES

Reference No. 13968

PROJECT: GM Powertrain Removal Action Project

OWNER: General Motors CONTRACT NO.: 13968(41, 89)

RE: Construction Meeting

LOCATION: Bedford, Indiana DATE: May 8, 2007 TIME: 2:00 p.m.

Participants:

Katie Kamm; CRA	Dan Nelson; CRA	Tim Hiltunen ; ENTACT
Hoekstra, Rick; CRA	Earney Funderburg; ENTACT	John Cooper; ENTACT
Terri Stewart; CRA	Ed Long; ENTACT	Barbara Longstreet; ENTACT
Yelena Moskvina; CRA	Edgar Longstreet; ENTACT	Randy Campbell; SES

Distribution:

Cheryl Hiatt; GM	Ed Peterson; GM	Glenn Turchan; CRA
Jim McGuigan; CRA	Jeff Daniel; CRA	Katie Kamm; CRA
Terri Channing; CRA	Mary Kelly; CRA	Peter Ramanauskas; USEPA
Brad Stimple; USEPA	Jerry O'Callaghan; IDEM	Jean Greensley; USEPA

<i>Item</i>	<i>Description</i>	<i>Action By</i>
<b>1.0</b>	<b>HEALTH AND SAFETY</b>	
1.1	ENTACT continues to perform dust monitoring in East Plant work areas.	ENTACT
1.2	ENTACT was reminded to use appropriate PPE – hardhat, gloves, tyvek. Frayed or torn tyvek is to be replaced.	ENTACT
1.3	Contractors will re-address road safety with all subcontractors and site personnel (i.e. speed, passing, narrow roads etc.). Truckers are to follow the site 25-mph speed restriction and allow safe passing for oncoming traffic.	ENTACT
1.4	On site truck vehicle speed is 5mph. Contractors will address with personnel and sub-contractors.	ENTACT
1.5	Contractors were reminded to properly dispose cigarette butts and debris in appropriate receptacles.	ENTACT/SES
<b>2.0</b>	<b>REQUEST FOR INFORMATION</b>	
2.1	ENTACT re-submitted a change order for the abandonment of the Outfall 003 structure on 05-07-07.	ENTACT
2.2	ENTACT was asked to submit a credit to GM for core hole and well abandonment due to the reduction in the number of abandonment locations.	ENTACT
2.3	ENTACT was asked to submit a revised organization chart and contact information.	ENTACT
2.4	ENTACT was asked to submit detailed information on the clean clay placement approach within the AOI-5 area (GM parking lot).	ENTACT
2.5	ENTACT was asked to submit a cost estimate for a generator to power the WW#3 pumps.	ENTACT
2.6	ENTACT was asked to submit updated insurance information on all sub-contractors.	ENTACT



Item	Description	Action By
<b>3.0</b>	<b>GENERAL WORK ACTIVITIES</b>	
3.1	CRA reviewed "Active", "Inactive", and "Non-Billable" workday tracking log. ENTACT accepted this week's log.	CRA
3.2	ENTACT continues place fill in 6-8" lifts and compact with 4 passes of the sheeps foot roller.	ENTACT
3.3	ENTACT was asked to address watering/sweeping of GM roads. The area north of EP entrance continues to be flooded rather than misted to keep dust down. ENTACT will implement road cleaning/dust control improvements to reduce tracking on GM drive (i.e. using less water during dusting by using the water truck's front sprayer and placing larger stone on haul roads to knock mud off the tires before entering the public roads).	ENTACT
3.4	CRA requested ENTACT's monthly trucking report be sent to Pete Bridcut (CRA).	ENTACT
3.5	CRA requested that ENTACT take sufficient photo documentation each month. Barbara Longstreet is now performing QA/QC for the East Plant and appropriate documentation is now being addressed.	ENTACT
3.6	Edgar Longstreet would be replacing Ed Long as Principle Field Project Manager.	ENTACT
3.7	ENTACT is working with the City of Bedford to address deteriorating road condition at GM drive and F street.	ENTACT
3.8	ENTACT is implementing additional measures to prevent soil from the off road trucks falling onto clean haul road.	ENTACT
3.9	ENTACT was advised to be more precise on scheduling – particularly tasks that involves CRA engineer oversite and sub-contractors. Costs incurred as a result of late cancellations or no shows will be billed to and paid by ENTACT.	ENTACT
3.9	ENTACT was advised to protect the fuel truck's hose during fueling and to follow appropriate decon procedures prior to the equipment leaving the site.	ENTACT
<b>4.0</b>	<b>GRADING AREAS # 1, 2, 3 AND 4, FILL AREAS (FA-1A &amp; FA-1B)</b>	
4.1	Water management activities and site maintenance work was conducted as appropriate.	ENTACT
4.2	ENTACT continues to confirm all required tarping is in place and secured prior to leaving at the end of the day. CRA continues to verify as acceptable.	ENTACT
4.3	ENTACT began using con-cover mulch as an alternate to the tarping of daily work areas (i.e. contained bermed daily work areas). CRA continues to verify as acceptable at the end of each workday.	ENTACT
4.4	ENTACT was advised to monitor approaching weather to allow for the necessary time to secure the work areas.	ENTACT
<b>5.0</b>	<b>VAULT AREA AOI7</b>	
5.1	SES continues to perform water management and site maintenance work as appropriate.	SES
5.2	The leachate collection sump pump failed on 05-05-07. McIntyre is repairing the non-working pump. A back-up pump was put into operation on 05-07-07. SES will advise CRA of pump repair status.	SES
5.3	SES will re-mulching the vault surface on 05-09-07.	SES



Item	Description	Action By
<b>6.0</b>	<b>SURFACE &amp; STORM WATER CONTROLS</b>	
6.1	ENTACT continues to maintain berm/sump enclosures at the fill placement areas to contain all surface water and continues to obtain CRA authorization prior to pumping water to the SES modu tanks.	ENTACT
6.2	SES and ENTACT redirected surface water storm water control piping from the East Plant to the modutanks on 05-08-07. A power failure to WW#3 was identified and SES was requested to continue pumping WW#3 via the 6" pump currently in place until power is restored.	ENTACT/SES
6.3	ENTACT was asked to monitor WW#3 pumps during normal water management activities.	ENTACT
<b>7.0</b>	<b>CAP/FILL PLACEMENT</b>	
7.1	ENTACT continues to receive <50-ppm material from the downstream parcels and is relocating material from FA-1A for placement as designed in the EP Cap fill areas.	ENTACT
7.2	CRA will provide ENTACT with the analytical information for the clean clay material received from Borrow Source 39-1.	CRA
<b>8.0</b>	<b>SITE STRUCTURES</b>	
8.1	ENTACT began installation of the Treated Water-Monitoring Chamber on 04-27-07. Completion is pending ENTACT's sub-contractor scheduling.	ENTACT
8.2	ENTACT began installation of the north and south 24" pipe concrete headwalls on 05-02-07. Completion is pending ENTACT's sub-contractor scheduling.	ENTACT
8.3	CRA advised ENTACT that Cinergy would be on site the week of 05-14-07 to remove the abandoned electrical lines in AOI-8. ENTACT will be responsible for removal and disposal of electrical poles.	ENTACT
8.4	ENTACT will provide a copy of PSI's compaction report for the #53 stone under the Treated Water Monitoring Chamber.	ENTACT
8.5	The abandonment of Outfall 003 is pending CRA approval. ENTACT was reminded to provide 24-hours notice prior to beginning this work allowing adequate notification by CRA to Dave Litherland (GM).	ENTACT
<b>9.0</b>	<b>WORK HOURS</b>	
9.1	ENTACT is working Monday through Saturday 7:00 a.m. to 5:30 p.m. water management crews on site as needed for storm water control.	ENTACT
9.2	SES is currently working M-T 10-hour days; water management crews on site as needed for storm water control.	SES
9.3	Contractors will be shut down from 05-26-07 through 05-28-07 for the Memorial Holiday weekend.	ENTACT/SES
<b>10.0</b>	<b>SUB-CONTRACTORS ON-SITE</b>	
10.1	Dave O'Mara Construction - ENTACT (Headwall and Treated Water Monitoring Chamber construction)	ENTACT

Attachments: \_\_\_\_\_



Prepared By: *TS* Ferri Stewart Date Issued: June 16, 2007

This confirms and records CRA's interpretation of the discussions that occurred and our understanding reached during this meeting. Unless notified in writing within 3 days of the date issued, we will assume that the following interpretation or description is complete and accurate.



## MEETING MINUTES

Reference No. 13968

PROJECT: GM Powertrain Removal Action Project

OWNER: General Motors CONTRACT NO.: 13968(41, 89)

RE: Construction Meeting

LOCATION: Bedford, Indiana DATE: May 15, 2007 TIME: 1:00 p.m.

**Participants:**

Katie Kamm; CRA	Earney Funderburg; ENTACT	Tim Hiltunen ; ENTACT
Terri Stewart; CRA	Edgar Longstreet; ENTACT	Barbara Longstreet; ENTACT
Dan Nelson; CRA	Ed Long; ENTACT	Randy Campbell; SES

**Distribution:**

Cheryl Hiatt; GM	Ed Peterson; GM	Glenn Turchan; CRA
Jim McGuigan; CRA	Jeff Daniel; CRA	Katie Kamm; CRA
Terri Channing; CRA	Mary Kelly; CRA	Peter Ramanauskas; USEPA
Brad Stimple; USEPA	Jerry O'Callaghan; IDEM	Jean Greensley; USEPA

<i>Item</i>	<i>Description</i>	<i>Action By</i>
<b>1.0</b>	<b>HEALTH AND SAFETY</b>	
1.1	ENTACT continues to perform dust monitoring in East Plant work areas.	ENTACT
1.2	ENTACT was reminded to put chocks on their water trucks wheels to prevent truck from rolling during filling up at F Street.	ENTACT
<b>2.0</b>	<b>REQUEST FOR INFORMATION</b>	
2.1	ENTACT provided an updated field organizational chart on 05-09-07.	ENTACT
2.2	ENTACT was reminded to provide updated subcontractor insurance copies to CRA.	ENTACT
2.3	ENTACT was reminded to submit detailed information on planned clean clay placement within the AOI-5 area (GM parking lot).	ENTACT
<b>3.0</b>	<b>GENERAL WORK ACTIVITIES</b>	
3.1	CRA reviewed "Active", "Inactive", and "Non-Billable" workday tracking log. ENTACT accepted this week's log.	CRA
3.2	ENTACT was reminded to protect the fuel truck's hose during fueling and to follow appropriate decon procedures prior to the equipment leaving the site.	ENTACT
3.3	ENTACT continues to place and compact fill.	ENTACT
3.4	ENTACT placed large stone at the East Plant truck entrance/exit on 05-09-07 to reduce track out (clean material) to GM Drive.	ENTACT
3.5	ENTACT will confirm subcontractor schedules prior to providing notice to CRA for work activities that require CRA engineers/subcontractors to be on site (e.g. concrete and rebar installation and inspection).	ENTACT
3.6	ENTACT will no longer use the vault ramp for deconning equipment. ENTACT will construct a temporary equipment decon pad at the dump ramp off the fill placement area.	ENTACT



<i>Item</i>	<i>Description</i>	<i>Action By</i>
<b>4.0</b>	<b>GRADING AREAS # 1, 2, 3 AND 4, FILL AREAS (FA-1A &amp; FA-1B)</b>	
4.1	Water management activities and site maintenance work were conducted as appropriate.	ENTACT
4.2	ENTACT continues to confirm tarping/mulching is complete prior to leaving at the end of the day. CRA continues to verify as acceptable.	ENTACT/CRA
<b>5.0</b>	<b>VAULT AREA AOI7</b>	
5.1	SES continues to perform water management and site maintenance work as appropriate.	SES
5.2	SES completed the re-mulching the vault surface on 05-10-07.	SES
<b>6.0</b>	<b>SURFACE &amp; STORM WATER CONTROLS</b>	
6.1	ENTACT continues to maintain berm/sump enclosures at the fill placement areas. ENTACT continues to obtain CRA authorization prior to pumping water to the SES modu tanks.	ENTACT
6.2	ENTACT was asked to include the monitoring of WW#3 pumps with normal water management activities.	ENTACT
<b>7.0</b>	<b>CAP/FILL PLACEMENT</b>	
7.1	ENTACT continues to receive <50-ppm material from the downstream parcels and relocate material from FA-1A.	ENTACT
7.2	CRA provided ENTACT with the analytical information for the clean clay material received from borrow source on 05-10-07.	CRA
<b>8.0</b>	<b>SITE STRUCTURES</b>	
8.1	ENTACT began installation of the treated water monitoring chamber on 04-27-07.	ENTACT
8.2	ENTACT began installation of the north and south 24" pipe concrete headwalls on 05-02-07.	ENTACT
8.3	ENTACT was advised that Cinergy removed the electrical lines in AOI-8 on 05-14-07. ENTACT will be responsible for the removal and disposal of abandoned electrical poles.	ENTACT
8.4	ENTACT provided a copy of PSI's compaction report for the #53 stone under the treated water monitoring chamber on 05-14-07.	ENTACT
8.5	ENTACT's abandonment of the Outfall 003 structure is on hold, pending sub-contractor scheduling.	ENTACT
8.6	ENTACT installed the exterior grout on the treated monitoring chamber's influent and effluent pipes on 05-11-07.	ENTACT
8.7	ENTACT was reminded to compact material around the treated water monitoring chamber piping in 1' lifts up to 2' above the pipe prior to using heavy equipment in area.	ENTACT
8.8	SES completed WW#3 cleaning on 05-08-07 and began cleaning the metering and lift stations on 05-14-07.	SES
<b>9.0</b>	<b>WORK HOURS</b>	
9.1	ENTACT is working Monday through Saturday 7:00 a.m. to 5:30 p.m.	ENTACT
9.2	SES is currently working M-T 10-hour days; water management crews on site as needed for storm water control.	SES





<i>Item</i>	<i>Description</i>	<i>Action By</i>
9.3	ENTACT will be shut down on 05-26-07 through 05-28-07, and SES from 05-25-07 through 05-28-07 for the Memorial Holiday weekend	ENTACT/SES
10.0	<b>SUB-CONTRACTORS ON-SITE</b>	
10.1	NA	

Attachments: \_\_\_\_\_

---

---

Prepared By: Terri Stewart Date Issued: July 11, 2007

This confirms and records CRA's interpretation of the discussions that occurred and our understanding reached during this meeting. Unless notified in writing within 3 days of the date issued, we will assume that the following interpretation or description is complete and accurate.



## MEETING MINUTES

Reference No. 13968

PROJECT: GM Powertrain Removal Action Project

OWNER: General Motors CONTRACT NO.: 13968(41, 89)

RE: Construction Meeting

LOCATION: Bedford, Indiana DATE: May 22, 2007 TIME: 1:00 p.m.

Participants:

Katie Kamm; CRA	Earney Funderburg; ENTACT	Randy Campbell; SES
Terri Stewart; CRA	Edgar Longstreet; ENTACT	Chris Bement; SES
Yelena Moskvina; CRA	John Cooper; ENTACT	
Dan Nelson; CRA	Barbara Longstreet; ENTACT	

Distribution:

Cheryl Hiatt; GM	Ed Peterson; GM	Glenn Turchan; CRA
Jim McGuigan; CRA	Jeff Daniel; CRA	Katie Kamm; CRA
Terri Channing; CRA	Mary Kelly; CRA	Peter Ramanauskas; USEPA
Brad Stimple; USEPA	Jerry O'Callaghan; IDEM	Jean Greensley; USEPA

<i>Item</i>	<i>Description</i>	<i>Action By</i>
<b>1.0</b>	<b>HEALTH AND SAFETY</b>	
1.1	ENTACT continues to perform dust monitoring in East Plant work areas.	ENTACT
1.2	ENTACT advised GM property access/utility clearances must be done in addition to private utility clearances prior to starting new work activities in new areas.	ENTACT
<b>2.0</b>	<b>REQUEST FOR INFORMATION</b>	
2.1	ENTACT was asked to provide sub-contractor Insurance copies to CRA. ENTACT anticipates the material will be compiled by 5-24-07.	ENTACT
2.2	ENTACT was asked to submit detailed GM parking lot clay construction schedule. ENTACT anticipates the material will be provided by 5-25-07.	ENTACT
2.3	ENTACT requested revised drawings for west of the WTP building to include recent HRC work.	ENTACT
2.4	ENTACT requested information on the removal of the 3 X 18" GM storm pipes.	ENTACT
<b>3.0</b>	<b>GENERAL WORK ACTIVITIES</b>	
3.1	CRA reviewed "Active", "Inactive", and "Non-Billable" workday tracking log. ENTACT accepted this week's log.	CRA
3.2	ENTACT continues place and compact (6-8" lifts, four passes) fill.	ENTACT
3.3	ENTACT to begin tree clearing on 05-22-07 provided all required utility clearances are complete for the work area, pending CRA approval.	ENTACT
3.4	ENTACT was told project neighbors will be parking in the East Plant parking area during public meetings scheduled on June 6, 7, and 8.	ENTACT



Item	Description	Action By
3.5	ENTACT placed larger rock at the East Plant truck haul road on 05-09-07 to reduce sediment transfer to GM Drive. CRA discussed the area 10-15' off GM Drive entrance/exit as this is the area where sediment transfer primarily occurs. ENTACT plans improve this area with an anticipated completion by 05-29-07. ENTACT was advised that CRA's trailer power and phone lines are under ground at this crossing. ENTACT to perform utility locate prior to dig.	ENTACT
4.0	<b>GRADING AREAS # 1, 2, 3 AND 4, FILL AREAS (FA-1A &amp; FA-1B)</b>	
4.1	Water management activities and site maintenance work was conducted as appropriate.	ENTACT
4.2	ENTACT continues to confirm required tarping/mulching is complete prior to leaving at the end of the day. CRA continues to verify as acceptable.	ENTACT
4.3	GA-1 tarping needs to be repaired.	ENTACT
5.0	<b>VAULT AREA AOI7</b>	
5.1	SES continues to perform water management and site maintenance work as appropriate.	SES
5.2	The leak detection sump could not be pumped from 05-22-07 to 05-25-07 as the Vac-Truck being relocated for WW#3 work. A 2 inch pump is in place as a back up but due to water levels being below 6 inches there is not sufficient head for the pump to start. Pumping will resume when water levels permit.	SES
6.0	<b>SURFACE &amp; STORM WATER CONTROLS</b>	
6.1	ENTACT continues to maintain berm/sump enclosures at the fill placement areas to contain all surface water and continues to obtain CRA authorization prior to pumping water to the SES modu tanks	ENTACT
6.2	ENTACT continues to monitor WW#3 pumps during normal water management activities.	ENTACT
6.3	SES attempted to reverse the influent pipe at WW#3 via a diesel pump to transfer water to the WTP on 05-23-07. During the revision it was found that a connection outside of WW#3 was damaged and in need of repair. SES repaired the connection on 05-24-07. Completion is pending the delivery of additional parts expected arrival 05-30-07.	SES
6.4	ENTACT is repairing the drainage ditch along the haul road to the west of the storm pond.	ENTACT
7.0	<b>CAP/FILL PLACEMENT</b>	
7.1	ENTACT continues to receive <50-ppm material from the downstream parcels and place the material in compacted lifts. ENTACT continues to cover/mulch the fill placement area daily.	ENTACT
7.2	CRA provided ENTACT the requested Borrow Area 39 information. ENTACT will stockpile the clean clay (for the cover system) in preparation for placement, additional testing to increase supply to be completed by CRA.	ENTACT
8.0	<b>SITE STRUCTURES</b>	
8.1	ENTACT began installation of the Treated Water-Monitoring Chamber on 04-27-07, completion pending ENTACT's sub-contractor scheduling.	ENTACT



<i>Item</i>	<i>Description</i>	<i>Action By</i>
8.2	ENTACT began installation of the north and south 24" pipe concrete headwalls on 05-02-07. Completion is pending ENTACT's sub-contractor scheduling.	ENTACT
8.3	ENTACT has confirmed O'Mara will be on site on May 24th & 25th for Outfall 003 abandonment.	ENTACT
8.4	ENTACT has confirmed O'Mara will be on site on 05-24 & 05-25 for rebar installation on headwall structures. Concrete to be poured on 05-29-07. CRA has scheduled inspection and testing personnel to be on site.	ENTACT
<b>9.0</b>	<b>WORK HOURS</b>	
9.1	ENTACT is working Monday through Saturday 7:00 a.m. to 5:30 p.m.	ENTACT
9.2	ENTACT/ SES will be shut down on 05-26-07 through 05-28-07 for the Memorial Holiday weekend.	ENTACT
9.3	SES is currently working M-T 10-hour days; water management crews on site as needed for storm water control.	SES
<b>10.0</b>	<b>SUB-CONTRACTORS ON-SITE</b>	
10.1	KMS - ENTACT utility locates	

Attachments: \_\_\_\_\_

Prepared By:  Terri Stewart \_\_\_\_\_ Date Issued: \_\_\_\_\_, 2007

This confirms and records CRA's interpretation of the discussions that occurred and our understanding reached during this meeting. Unless notified in writing within 3 days of the date issued, we will assume that the following interpretation or description is complete and accurate.



## MEETING MINUTES

Reference No. 13968

PROJECT: GM Powertrain Removal Action Project

OWNER: General Motors CONTRACT NO.: 13968(41, 89)

RE: Construction Meeting

LOCATION: Bedford, Indiana DATE: May 30, 2007 TIME: 1:00 p.m.

**Participants:**

Terri Stewart; CRA	Earney Funderburg; ENTACT	Barbara Longstreet; ENTACT
Yelena Moskvina; CRA	Edgar Longstreet; ENTACT	Randy Campbell; SES
Jeff Maranciak; CRA	Tim Hiltunen; ENTACT	Chris Bement; SES
	John Cooper; ENTACT	

**Distribution:**

Cheryl Hiatt; GM	Ed Peterson; GM	Glenn Turchan; CRA
Jim McGuigan; CRA	Jeff Daniel; CRA	Katie Kamm; CRA
Terri Channing; CRA	Mary Kelly; CRA	Peter Ramanauskas; USEPA
Brad Stimple; USEPA	Jerry O'Callaghan; IDEM	Jean Greensley; USEPA

<i>Item</i>	<i>Description</i>	<i>Action By</i>
<b>1.0</b>	<b>HEALTH AND SAFETY</b>	
1.1	ENTACT continues to perform dust monitoring in East Plant work areas.	ENTACT
1.2	ENTACT was reminded site vehicles must adhere to the on-site speed limit of 5mph.	ENTACT
<b>2.0</b>	<b>REQUEST FOR INFORMATION</b>	
2.1	ENTACT provided subcontractor insurance copies to CRA on 05-24-07.	ENTACT
2.2	ENTACT was requested to submit detailed GM parking lot clay construction schedule.	ENTACT
2.3	ENTACT requested revised drawings for the area west of the WTP building to include recent HRC work.	ENTACT
2.4	ENTACT requested information on the removal of the three 18" GM storm pipes (from outfall 002 to the storm pond).	ENTACT
2.5	CRA requested ENTACT provide a complete updated schedule prior to the monthly meeting scheduled for June 5, 2007.	ENTACT
<b>3.0</b>	<b>GENERAL WORK ACTIVITIES</b>	
3.1	CRA reviewed "Active", "Inactive", and "Non-Billable" workday tracking log. ENTACT accepted this week's log.	CRA
3.2	ENTACT continues to place and compact fill.	ENTACT
3.3	ENTACT's subcontractor, Dwight Smith Logging, began tree clearing on 05-22-07 along East Plant's eastern perimeter.	DSL
3.4	ENTACT completed the haul road entrance to East Plant re-construction on 05-29-07.	--



<i>Item</i>	<i>Description</i>	<i>Action By</i>
3.5	ENTACT completed removal and distribution of existing rock pile on 05-24-07.	--
<b>4.0</b>	<b>GRADING AREAS # 1, 2, 3 AND 4, FILL AREAS (FA-1A &amp; FA-1B)</b>	
4.1	Water management activities and site maintenance work were conducted as appropriate.	ENTACT
4.2	ENTACT continues to confirm tarping/mulching is complete prior to leaving at the end of the day. CRA continues to verify as acceptable.	ENTACT/CRA
<b>5.0</b>	<b>VAULT AREA AOI7</b>	
5.1	SES continues to perform water management and site maintenance work as appropriate.	SES
<b>6.0</b>	<b>SURFACE &amp; STORM WATER CONTROLS</b>	
6.1	ENTACT continues to maintain berm/sump enclosures at the fill placement areas. ENTACT continues to obtain CRA authorization prior to pumping water to the SES modu tanks	ENTACT
6.2	ENTACT continues to monitor WW#3 pumps during normal water management activities. SES was asked to maintain and inspect the pumps.	ENTACT/SES
6.3	ENTACT completed repairing the drainage ditch along the haul road to the west of the storm pond by removing sediment material and installing new straw bales and silt fence on 05-25-07.	ENTACT
6.4	ENTACT will securely tarp areas around North and South end of the 24" pipes.	ENTACT
<b>7.0</b>	<b>CAP/FILL PLACEMENT</b>	
7.1	ENTACT continues to receive <50-ppm material from the downstream parcels and place the material in compacted lifts. ENTACT continues to cover/mulch the fill placement area daily.	ENTACT
<b>8.0</b>	<b>SITE STRUCTURES</b>	
8.1	North headwall work will resume on 05-31-07.	ENTACT
8.2	ENTACT completed the abandonment of the Outfall 003 structure on 05-25-07.	--
8.3	ENTACT completed hand compacting material around the treated water monitoring chamber and connecting pipe on 05-30-07.	--
<b>9.0</b>	<b>WORK HOURS</b>	
9.1	ENTACT is working Monday through Saturday 7:00 a.m. to 5:30 p.m.	ENTACT
9.2	SES is currently working M-T 10-hour days; water management crews on site as needed for storm water control.	SES
<b>10.0</b>	<b>SUB-CONTRACTORS ON-SITE</b>	
10.1	KMS – ENTACT utility locates	ENTACT
10.2	Dave O'Mara Contractors – ENTACT Outfall 003	ENTACT
10.3	Dwight Smith Logging – ENTACT Tree clearing east perimeter	ENTACT



Attachments: \_\_\_\_\_

Prepared By: Terri Stewart Date Issued: July 11, 2007

This confirms and records CRA's interpretation of the discussions that occurred and our understanding reached during this meeting. Unless notified in writing within 3 days of the date issued, we will assume that the following interpretation or description is complete and accurate.



## MEETING MINUTES

Reference No. 13968

PROJECT: GM Powertrain Removal Action Project  
 OWNER: General Motors CONTRACT NO.: 13968(41, 89)  
 RE: Construction Meeting  
 LOCATION: Bedford, Indiana DATE: June 5, 2007 TIME: 1:00 p.m.

**Participants:**

Terri Stewart; CRA	Earney Funderburg; ENTACT	Randy Campbell; SES
Yelena Moskvina; CRA	Edgar Longstreet; ENTACT	Chris Bement; SES
Dan Nelson; CRA	Tim Hiltunen; ENTACT	
Rick Hoekstra; CRA	Barbara Longstreet; ENTACT	

**Distribution:**

Cheryl Hiatt; GM	Ed Peterson; GM	Glenn Turchan; CRA
Jim McGuigan; CRA	Jeff Daniel; CRA	Katie Kamm; CRA
Terri Channing; CRA	Mary Kelly; CRA	Peter Ramanauskas; USEPA
Brad Stimple; USEPA	Jerry O'Callaghan; IDEM	Jean Greensley; USEPA

<i>Item</i>	<i>Description</i>	<i>Action By</i>
<b>1.0</b>	<b>HEALTH AND SAFETY</b>	
1.1	ENTACT continues to perform dust monitoring in East Plant work areas.	ENTACT
1.2	The contractors will implement additional security measures to control site access.	ENTACT
1.3	Contractors were asked to remind site workers to act in a professional manner. Inappropriate reading material has been found at the site. Radios are to be limited to work related issues.	ENTACT
1.4	CRA requested 24-hour advance notice when possible prior to any activity requiring confined space access.	ENTACT
1.5	Contractors were asked to remind site workers and sub contractors to follow SWA (Stop Work Authority) during severe weather.	ENTACT
1.6	Appropriate PPE (specific to the task) is to be worn by personnel (including sub-contractors) while on site. ENTACT will remind mechanics that tyvek and gloves are required when working on equipment within the EZ. WW#3 area is now considered Level D PPE.	ENTACT/SES
<b>2.0</b>	<b>REQUEST FOR INFORMATION</b>	
2.1	ENTACT was requested on 05-08-07 to submit detailed GM parking lot Clay Construction Schedule.	ENTACT
2.2	ENTACT requested revised drawings for west of the WTP building to include recent HRC work, CRA anticipates drawings out by 06-08-07.	ENTACT
2.3	ENTACT requested information on the removal of the three 18" GM storm pipes.	ENTACT





<i>Item</i>	<i>Description</i>	<i>Action By</i>
2.4	CRA requested product samples (i.e. geotextile, turf reinforcement mat, and erosion control blanket).	ENTACT
<b>3.0</b>	<b>GENERAL WORK ACTIVITIES</b>	
3.1	CRA reviewed "Active", "Inactive", and "Non-Billable" workday tracking log. ENTACT accepted this week's log.	CRA
3.2	ENTACT continues to place and compact fill.	ENTACT
3.3	ENTACT's subcontractor, Dwight Smith Logging, continues tree clearing along East Plant's eastern perimeter.	DSL
3.4	ENTACT continues wetting roadways for dust control during the approved times (i.e. 8:00 to 10:00 a.m., 1:00 to 2:30 p.m., and after 4:00 p.m.). There are no restrictions on the operation of the street sweeper.	ENTACT
3.5	ENTACT will improve <50-ppm loading areas to continue to prevent off road vehicles from transferring impacted material onto clean haul roads.	ENTACT
3.6	ENTACT's downstream water truck allows minimal water build up on roads due to misting abilities of nozzles on truck. ENTACT will investigate retro fitting East Plant water truck with similar nozzles.	ENTACT
3.7	ENTACT will implement added measures to control soil buildup on tires prior to allowing truck traffic on GM Drive following rain events. CRA noted if this issue can not be corrected a tire wash at all entrances will be required.	ENTACT
3.8	ENTACT was asked to remove personal vehicles from East Plant parking lot for GM's public meetings on June 6 <sup>th</sup> and 7 <sup>th</sup> between 6pm to 8pm and on June 8 <sup>th</sup> between 11am to 1pm.	ENTACT
<b>4.0</b>	<b>GRADING AREAS # 1, 2, 3 AND 4, FILL AREAS (FA-1A &amp; FA-1B)</b>	
4.1	Water management activities and site maintenance work were conducted as appropriate.	ENTACT
4.2	ENTACT continues to confirm tarping/mulching is complete prior to leaving at the end of the day. CRA continues to verify as acceptable.	ENTACT
4.3	ENTACT was reminded mulching is to be used in active work areas only.	ENTACT
<b>5.0</b>	<b>VAULT AREA AOI7</b>	
5.1	SES continues to perform water management and site maintenance work as appropriate.	SES
5.2	The vac-truck will no longer be used to pump the Leak Detection Sump; the existing 2" pump will remain in placed and the sump will be pumped as needed. SES will continue to take daily water level readings.	SES
5.3	SES to check on repaired pump from leachate Collection Sump.	SES
<b>6.0</b>	<b>SURFACE &amp; STORM WATER CONTROLS</b>	
6.1	ENTACT continues to maintain berm/sump enclosures at the fill placement areas. ENTACT continues to obtain CRA authorization prior to pumping water to the SES modu tanks	ENTACT
6.2	SES continues to maintain and inspect WW#3 pumps. ENTACT was asked to continue to monitor WW#3 during normal water management activities.	ENTACT/SES
6.3	SES is waiting for additional parts to modify the influent pipe at WW#3 via a diesel pump to transfer water to the WTP.	SES



<i>Item</i>	<i>Description</i>	<i>Action By</i>
<b>7.0</b>	<b>CAP/FILL PLACEMENT</b>	
7.1	ENTACT continues to receive <50-ppm material from the downstream parcels and place the material in compacted lifts. ENTACT continues to cover/mulch the fill placement area daily.	ENTACT
<b>8.0</b>	<b>SITE STRUCTURES</b>	
8.1	On 06-01-07 ENTACT began placing concrete into the treated water monitoring chamber to form the benching. The onset of a severe lightening storm during construction prevented the benching from being completed prior to the concrete hardening. ENTACT will submit a plan as to how the hardened concrete will now be formed.	ENTACT
8.2	ENTACT completed the north headwalls on 06-01-07. Concrete results are pending.	ENTACT
8.3	South headwall construction was halted on 05-24-07 due to bedrock being encountered at shallower elevations than expected. Exploratory excavation of this area to identify the bedrock surface was completed on 05-30-07.	ENTACT
8.4	ENTACT used additional sealant to ensure a watertight seal on the treated water monitoring chamber risers prior to back filling around structure.	ENTACT
<b>9.0</b>	<b>WORK HOURS</b>	
9.1	ENTACT is working Monday through Saturday 7:00 a.m. to 5:30 p.m.	ENTACT
9.2	SES is currently working M-T 10-hour days. Water management crews are on site as needed for storm water control.	SES
<b>10.0</b>	<b>SUB-CONTRACTORS ON-SITE</b>	
10.1	Dave O'Mara Contractors – ENTACT North Headwall & Treated Water Monitoring Chamber	ENTACT
10.2	Dwight Smith Logging – ENTACT Tree clearing eastern perimeter	ENTACT

Attachments: \_\_\_\_\_

Prepared By:  Terri Stewart \_\_\_\_\_ Date Issued: July 11, 2007

This confirms and records CRA's interpretation of the discussions that occurred and our understanding reached during this meeting. Unless notified in writing within 3 days of the date issued, we will assume that the following interpretation or description is complete and accurate.



## MEETING MINUTES

Reference No. 13968

PROJECT: GM Powertrain Removal Action Project  
 OWNER: General Motors CONTRACT NO.: 13968(41, 89)  
 RE: Construction Meeting  
 LOCATION: Bedford, Indiana DATE: June 12, 2007 TIME: 1:00 p.m.

Participants:

Terri Stewart; CRA	Eamey Funderburg; ENTACT	Barbara Longstreet; ENTACT
Yelena Moskvina; CRA	Edgar Longstreet; ENTACT	Randy Campbell; SES
Dan Nelson; CRA	Tim Hiltunen; ENTACT	

Distribution:

Cheryl Hiatt; GM	Ed Peterson; GM	Glenn Turchan; CRA
Jim McGuigan; CRA	Jeff Daniel; CRA	Katie Kamm; CRA
Terri Channing; CRA	Mary Kelly; CRA	Peter Ramanauskas; USEPA
Brad Stimple; USEPA	Jerry O'Callaghan; IDEM	Jean Greensley; USEPA

<i>Item</i>	<i>Description</i>	<i>Action By</i>
<b>1.0</b>	<b>HEALTH AND SAFETY</b>	
1.1	ENTACT continues to perform dust monitoring in East Plant work areas.	ENTACT
1.2	John Cooper (ENTACT H&S) will be away from the site this week. Barbara Longstreet will temporarily assume the safety officer role.	ENTACT
1.3	ENTACT acknowledged tornado shelter location.	ENTACT
1.4	ENTACT will mark the east side of WW#3 to define the no-tyvek zone.	ENTACT
<b>2.0</b>	<b>REQUEST FOR INFORMATION</b>	
2.1	CRA provided ENTACT with revised drawings for East Plant Cap construction on 06-12-07.	ENTACT
2.2	ENTACT requested information on the removal of the three 18" GM storm pipes.	ENTACT
<b>3.0</b>	<b>GENERAL WORK ACTIVITIES</b>	
3.1	CRA reviewed "Active", "Inactive", and "Non-Billable" workday tracking log. ENTACT accepted this week's log.	CRA
3.2	ENTACT continues to place and compact fill. CRA requested ENTACT add moisture to the material to assist in compaction and dust control.	ENTACT
3.3	ENTACT's subcontractor, Dwight Smith Logging, completed tree clearing on 06-12-07 along East Plant's eastern perimeter.	--
3.4	ENTACT continues to implement added measures to control tire track out to GM Drive.	ENTACT
3.5	ENTACT is investigating options for support Area relocation within the East Plant area.	ENTACT



Item	Description	Action By
3.6	ENTACT was told parking is no longer permitted on GM property across from the Bailey Scales entrance.	ENTACT
3.7	ENTACT continues to place construction fence and silt fence along the eastern perimeter.	ENTACT
4.0	<b>GRADING AREAS # 1, 2, 3 AND 4, FILL AREAS (FA-1A &amp; FA-1B)</b>	
4.1	Water management activities and site maintenance work were conducted as appropriate.	ENTACT
4.2	ENTACT continues to confirm tarping/mulching is complete prior to leaving at the end of the day. CRA continues to verify as acceptable.	ENTACT
5.0	<b>VAULT AREA AOI7</b>	
5.1	SES continues to perform water management and site maintenance work as appropriate.	SES
5.2	SES was requested to re-mulch the vault surface area by the end of next week.	SES
6.0	<b>SURFACE &amp; STORM WATER CONTROLS</b>	
6.1	ENTACT continues to maintain berm/sump enclosures at the fill placement areas. ENTACT continues to obtain CRA authorization prior to pumping water to the SES modu tanks	ENTACT
6.2	Contractors continue to maintain and inspect WW#3.	ENTACT/SES
6.3	SES plans to modify the influent pipe at WW#3 via a diesel pump transferring water to the WTP on 06-13-07.	SES
7.0	<b>CAP/FILL PLACEMENT</b>	
7.1	ENTACT continues to receive <50-ppm material from the downstream parcels and place the material in compacted lifts. ENTACT continues to cover/mulch the fill placement area daily.	ENTACT
8.0	<b>SITE STRUCTURES</b>	
8.1	The treated water monitoring chamber benching, platform placement, and lid closure were completed on 06-07-07.	ENTACT
8.2	The north headwall concrete results are pending the 28-day breaks.	ENTACT
9.0	<b>WORK HOURS</b>	
9.1	ENTACT is working Monday through Saturday 7:00 a.m. to 5:30 p.m.	ENTACT
9.2	SES is currently working M-T 10-hour days. Water management crews are on site as needed for storm water control.	SES
10.0	<b>SUB-CONTRACTORS ON-SITE</b>	
10.1	Dave O'Mara Contractors – ENTACT North Headwall & Treated Water Monitoring Chamber	ENTACT
10.2	Dwight Smith Logging – ENTACT tree clearing eastern perimeter	ENTACT

Attachments: \_\_\_\_\_

Prepared By:  Terri Stewart

Date Issued: July 11, 2007



This confirms and records CRA's interpretation of the discussions that occurred and our understanding reached during this meeting. Unless notified in writing within 3 days of the date issued, we will assume that the following interpretation or description is complete and accurate.



## MEETING MINUTES

Reference No. 13968

PROJECT: GM Powertrain Removal Action Project  
 OWNER: General Motors CONTRACT NO.: 13968(41, 89)  
 RE: Construction Meeting  
 LOCATION: Bedford, Indiana DATE: June 19, 2007 TIME: 1:00 p.m.

Participants:

Terri Stewart; CRA	Edgar Longstreet; ENTACT	Barbara Longstreet; ENTACT
Yelena Moskvina; CRA	Tim Hiltunen; ENTACT	Randy Campbell; SES
Dan Nelson; CRA	John Cooper; ENTACT	Chris Bement; SES

Distribution:

Cheryl Hiatt; GM	Ed Peterson; GM	Glenn Turchan; CRA
Jim McGuigan; CRA	Jeff Daniel; CRA	Katie Kamm; CRA
Terri Channing; CRA	Mary Kelly; CRA	Peter Ramanauskas; USEPA
Brad Stimple; USEPA	Jerry O'Callaghan; IDEM	Jean Greensley; USEPA

<i>Item</i>	<i>Description</i>	<i>Action By</i>
<b>1.0</b>	<b>HEALTH AND SAFETY</b>	
1.1	ENTACT continues to perform dust monitoring in East Plant work areas.	ENTACT
1.2	Contractors are monitoring site workers for heat related illnesses - particularly during high temperature months.	ENTACT
1.3	Site personnel must abide by the 5 mph speed limit inside the East Plant work area. Violations will not be tolerated.	ENTACT
1.4	ENTACT placed construction fence to delineate the "no-tyvek" zone around WW#3.	ENTACT
<b>2.0</b>	<b>REQUEST FOR INFORMATION</b>	
2.1	CRA requested detailed plan from ENTACT to use half of GM parking lot for their support area.	ENTACT
2.2	ENTACT provided a cost estimate to uncover and repair the 8" force main from WW#3 to the WTP.	ENTACT
2.3	ENTACT was asked to submit monthly photos within one week following month end.	ENTACT
2.4	CRA reviewed and requested additional revisions to ENTACT's clay Placement Plan.	ENTACT
<b>3.0</b>	<b>GENERAL WORK ACTIVITIES</b>	
3.1	CRA reviewed "Active", "Inactive", and "Non-Billable" workday tracking log. ENTACT accepted this week's log.	CRA
3.2	ENTACT continues to place and compact fill.	ENTACT
3.3	Contractors were advised CRA would be off-site on Tuesday, 06-26-07 from 11am to 1pm, the weekly meeting is rescheduled to 2pm.	ENTACT/SES
3.4	The next monthly meeting is scheduled for 06-10-07 at 1pm.	



<i>Item</i>	<i>Description</i>	<i>Action By</i>
3.5	ENTACT continues to place silt fence as work progresses.	ENTACT
3.6	ENTACT continues to place/repair construction fence and silt fence along east perimeter.	ENTACT
<b>4.0</b>	<b>GRADING AREAS # 1, 2, 3 AND 4, FILL AREAS (FA-1A &amp; FA-1B)</b>	
4.1	Water management activities and site maintenance work were conducted as appropriate.	ENTACT
4.2	ENTACT continues to confirm tarping/mulching is complete prior to leaving at the end of the day. CRA continues to verify as acceptable.	ENTACT
4.3	ENTACT was reminded to use sufficient amount of mulch material to thoroughly cover exposed surface areas.	ENTACT
<b>5.0</b>	<b>VAULT AREA AOI7</b>	
5.1	SES continues to perform water management and site maintenance work as appropriate.	SES
5.2	SES will begin recovering the vault with con-cover (mulch) on 06-20-07.	SES
5.3	SES was asked not to pump the vault sumps due to CRA sampling in the AM on 06-20-07; pumping can resume following testing.	SES
<b>6.0</b>	<b>SURFACE &amp; STORM WATER CONTROLS</b>	
6.1	ENTACT continues to maintain berm/sump enclosures at the fill placement areas. ENTACT continues to obtain CRA authorization prior to pumping water to the SES modu tanks	ENTACT
6.2	Both contractors continue to maintain and inspect WW#3.	ENTACT/SES
6.3	SES was not able to modify the influent pipe at WW#3 via a diesel pump transferring water to the WTP on 06-13-07 due to apparent damage/collapse of the 8" force main. WW#3 will continue to be pumped to the SES modu tanks in the interim.	SES
<b>7.0</b>	<b>CAP/FILL PLACEMENT</b>	
7.1	ENTACT continues to receive <50-ppm material from the downstream parcels. ENACT began relocating <50-ppm material from GA-3 on 06/15/07. ENTACT continues to cover/mulch the fill placement area daily.	ENTACT
7.2	ENTACT began constructing a new haul road extending to the top of GA-2 on 06-16-07.	ENTACT
7.3	ENTACT began stockpiling clay from Borrow Source Area 39-1 on 06-08-07 in anticipation of clay placement beginning 6/27/07.	ENTACT
<b>8.0</b>	<b>SITE STRUCTURES</b>	
8.1	The north headwall concrete results are pending 28-day breaks.	ENTACT
<b>9.0</b>	<b>WORK HOURS</b>	
9.1	ENTACT is working Monday through Saturday 7:00 a.m. to 5:30 p.m.	ENTACT
9.2	SES is currently working M-T 10-hour days. Water management crews are on site as needed for storm water control.	SES
9.3	SES will have limited crew availability the week of 07-02-07 through 07-08-07.	SES
9.4	ENTACT/SES will not be working on 07-04-07 due to the Independence Day holiday. Water management crews will be on site as needed.	ENTACT/SES



<i>Item</i>	<i>Description</i>	<i>Action By</i>
<b>10.0</b>	<b>SUB-CONTRACTORS ON-SITE</b>	
10.1	Dave O'Mara Contractors – ENTACT North Headwall & Treated Water Monitoring Chamber	ENTACT
10.2	Dwight Smith Logging – ENTACT tree clearing eastern perimeter	ENTACT

Attachments: \_\_\_\_\_

Prepared By:  Terri Stewart Date Issued: July 11, 2007

This confirms and records CRA's interpretation of the discussions that occurred and our understanding reached during this meeting. Unless notified in writing within 3 days of the date issued, we will assume that the following interpretation or description is complete and accurate.





## MEETING MINUTES

Reference No. 13968

PROJECT: GM Powertrain Removal Action Project

OWNER: General Motors CONTRACT NO.: 13968(41, 89)

RE: Construction Meeting

LOCATION: Bedford, Indiana DATE: June 26, 2007 TIME: 2:00 p.m.

**Participants:**

Katie Kamm; CRA	Dan Nelson; CRA	John Cooper; ENTACT
Rick Hoekstra; CRA	Earney Funderburg; ENTACT	Barbara Longstreet; ENTACT
Terri Stewart; CRA	Edgar Longstreet; ENTACT	Randy Campbell; SES
Yelena Moskvina; CRA	Tim Hiltunen; ENTACT	Chris Bement; SES

**Distribution:**

Cheryl Hiatt; GM	Ed Peterson; GM	Glenn Turchan; CRA
Jim McGuigan; CRA	Jeff Daniel; CRA	Katie Kamm; CRA
Terri Channing; CRA	Mary Kelly; CRA	Peter Ramanauskas; USEPA
Brad Stimple; USEPA	Jerry O'Callaghan; IDEM	Jean Greensley; USEPA

<i>Item</i>	<i>Description</i>	<i>Action By</i>
<b>1.0</b>	<b>HEALTH AND SAFETY</b>	
1.1	ENTACT continues to perform dust monitoring in East Plant work areas.	ENTACT
1.2	CRA commended ENTACT on their field personnel's immediate response to the Stop Work Authorities called during recent lightning events.	ENTACT
1.3	ENTACT continues to repair and replace construction fencing delineating exclusion and work zones.	ENTACT
1.4	ENTACT was asked to perform a double-check of the newly constructed dump ramp located on top of GA-2 with respect to the ramp's ability to safely support off-road and on-road trucks during dumping activities.	ENTACT
<b>2.0</b>	<b>REQUEST FOR INFORMATION</b>	
2.1	ENTACT has requested the use of several locations for a new support area. <ol style="list-style-type: none"> <li>1. Bailey Scale Road location - CRA approved with noted stipulations on road use and traffic restrictions.</li> <li>2. Half of the GM Parking lot after partial restoration -pending - additional details were requested by CRA on 06-14-07. The location was tabled by ENTACT on 06-25-07.</li> <li>3. AOI 8 area, following the removal of &gt; 50 ppm soil stockpiled by HRC - ENTACT continues to review this option as a lay down area.</li> <li>4. Parcel 412 - pending GM approval.</li> </ol>	ENTACT/CRA
2.3	CRA is currently reviewing recent revisions to ENTACT's Clay Placement Plan (received 06-22-07).	CRA
2.4	CRA requested ENTACT provided T&M back-up information for Outfall 003 work performed on 05-24 & 25-07.	ENTACT



Item	Description	Action By
<b>3.0</b>	<b>GENERAL WORK ACTIVITIES</b>	
3.1	CRA reviewed "Active", "Inactive", and "Non-Billable" workday tracking log. ENTACT disagreed that 06-23-07 was a non-billable day. ENTACT worked from 7:00 to 9:42 and shut down due to storms. CRA noted this item would be reviewed and GM/CRA would respond back to ENTACT by EOB on 06-26-07. <i>CRA advised ENTACT on 06-26-07 that 06-23-07 would remain a "Non Billable day."</i>	CRA/ENTACT
3.2	ENTACT continues to place and compact fill.	ENTACT
3.3	ENTACT continues to place silt fence as work progresses.	ENTACT
3.4	Task directives and specification requirements are to be followed unless prior approval is obtained.	ENTACT
3.5	ENTACT was reminded con-cover (mulch) is to be used in active fill placement areas enclosed within a bermed structure.	ENTACT
3.6	Air-monitoring station 23A was relocated to the Bailey Scales gate entrance and is now identified as Station 23B. Station 29 was relocated to the RDNP lay down area and is now identified as Station 29A. ENTACT relocated the generator power supplies to both stations immediately following their relocation.	ENTACT
3.8	The CRA East Plant field trailer will be relocated to the NW corner outside the perimeter of the parking lot.	ENTACT
4.0	<b>GRADING AREAS # 1, 2, 3 AND 4, FILL AREAS (FA-1A &amp; FA-1B)</b>	
4.1	Water management activities and site maintenance work were conducted as appropriate.	ENTACT
4.2	ENTACT continues to confirm tarping/mulching is complete prior to leaving at the end of the day. CRA continues to verify as acceptable.	ENTACT
4.3	ENTACT was asked to re-mulch exposed surface area where mulch has deteriorated as a result of the recent rain events.	ENTACT
5.0	<b>CAP/FILL PLACEMENT</b>	
5.1	ENTACT continues to receive <50-ppm material from the downstream parcels and from excavation areas within the East Plant cap area for placement. ENTACT continues to cover/mulch the fill placement area daily.	ENTACT
5.2	ENTACT began using the haul road extending to the top of GA-2 for fill placement on 06-21-07.	ENTACT
5.3	Fill placement activities were shut down on 06-22-07 all day and shut down at 9:42 AM for the remainder of the day on 06-24-06 due to weather.	ENTACT
6.0	<b>VAULT AREA AOI7</b>	
6.1	SES continues to perform water management and site maintenance work as appropriate.	SES
6.2	SES re-mulched the vault surface area on 06-20-07.	SES
6.3	CRA sampled the vault sumps on 06-20-07.	SES
7.0	<b>DRAINAGE DITCH EXCAVATION</b>	
7.1	ENTACT anticipates starting construction of the perimeter drainage ditch on the East Side of GA-2 on 06-25-07. CRA advised all disturbed surface areas are to be tarped, mulch is not an acceptable cover for this area.	ENTACT



<i>Item</i>	<i>Description</i>	<i>Action By</i>
<b>8.0</b>	<b>PARKING LOT RESTORATION</b>	
8.1	ENTACT was asked to provide parking lot survey data for verification of elevation requirements.	ENTACT
8.2	ENTACT anticipates clay placement in the east parking lot will begin on 06-28-07 pending approval of the Clay Placement Plan and survey data.	ENTACT
8.3	SES will relocate vault liner material from the East Plant parking lot by 06-28-07.	SES
<b>9.0</b>	<b>SITE STRUCTURES</b>	
9.1	No new structure installation performed during this reporting period.	- -
<b>10.0</b>	<b>SURFACE &amp; STORM WATER CONTROLS</b>	
10.1	ENTACT continues to maintain berm/sump enclosures at the fill placement areas. ENTACT continues to obtain CRA authorization prior to pumping water to the SES modu tanks	ENTACT
10.2	Both contractors continue to maintain and inspect WW#3.	ENTACT/SES
<b>11.0</b>	<b>WORK HOURS</b>	
11.1	ENTACT is working Monday through Saturday 7:00 a.m. to 5:30 p.m.	ENTACT
11.2	ENTACT/SES will not be working on 07-04-07 due to the Independence Day holiday. Water management crews will be on site as needed.	ENTACT/SES
11.3	SES is currently working M-T 10-hour days. Water management crews are on site as needed for storm water control.	SES
11.4	SES will have limited crew availability the week of 07-02-07 through 07-08-07.	SES
<b>12.0</b>	<b>SUB-CONTRACTORS ON-SITE</b>	
12.1	Bledsoe, Tapp & Guertazz – ENTACT Surveying	ENTACT

Attachments: \_\_\_\_\_

Prepared By:  Terri Stewart Date Issued: July 11, 2007

This confirms and records CRA's interpretation of the discussions that occurred and our understanding reached during this meeting. Unless notified in writing within 3 days of the date issued, we will assume that the following interpretation or description is complete and accurate.