



GM POWERTRAIN BEDFORD FACILITY BEDFORD, INDIANA

RCRA CORRECTIVE ACTION/CERCLA REMOVAL ACTION

GM POWERTRAIN BEDFORD PLANT, BEDFORD, INDIANA

Welcome to the June 2008 Public Information Session June 19, 2008



- Facility located on 152.5 acres and is approximately 1,000,000 square feet
- Approximately 1,000 employees



REMOVAL ACTION

RCRA CORRECTIVE ACTION/CERCLA REMOVAL ACTION

G M P O W E R T R A I N B E D F O R D P L A N T , B E D F O R D , I N D I A N A

- Comprehensive Environmental Response, Compensation, and Liability Act (CERCLA) Removal Action (RA)
 - Bailey's Branch and Pleasant Run PCB cleanup of creek sediments and floodplain soil.
 - RA Elements:
 - Control of impacted springs and seeps along creeks;
 - Removal of floodplain soil to 1.8 ppm and sediment to 1 ppm in the creek.
 - On-Site and off-Site work is being consolidated to speed up progress.
 - Excavation of creek sediments and floodplain soil should be completed in summer 2008, however restoration of excavated areas and transportation of soil from staging area to East Plant Area will continue through 2008 and into 2009.



RCRA CORRECTIVE ACTION/CERCLA REMOVAL ACTION

GM POWERTRAIN BEDFORD PLANT, BEDFORD, INDIANA

BORROW SOURCE AREA

EXCAVATION

**RESTORATION
NORTH OF
BROOMSAGE ROAD**

**NORTHERN
TRIBUTARY**

WEST PLANT AREA

EAST PLANT AREA

PARCEL 201





REMOVAL ACTION STATUS

RCRA CORRECTIVE ACTION/CERCLA REMOVAL ACTION

GM POWERTRAIN BEDFORD PLANT, BEDFORD, INDIANA

DIVERSION
CHANNEL NO. 3

BORROW SOURCE
AREA AND HAUL
ROAD

NEW RESTORATION
BETWEEN
BROOMSAGE ROAD
AND PEERLESS
ROAD

NORTHERN
TRIBUTARY

EAST PLANT AREA
VAULT

PARCEL 201

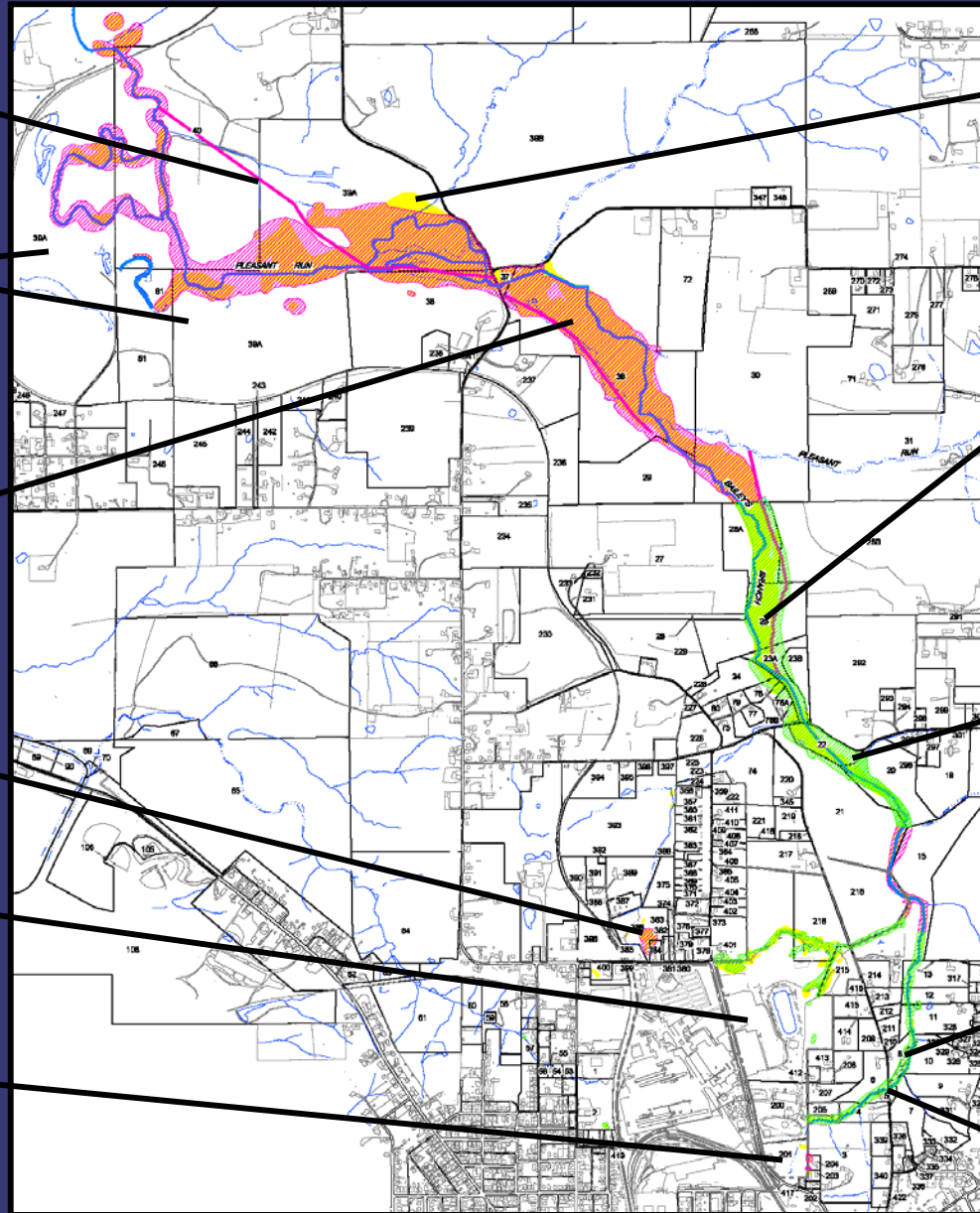

STAGING AREA

RESTORATION
NORTH OF
BROOMSAGE ROAD

RESTORATION
SOUTH OF
BROOMSAGE ROAD

RESTORATION
EAST OF BAILEY
SCALES ROAD

RESTORATION
WEST OF BAILEY
SCALES ROAD



CREEK RESTORATION

RCRA CORRECTIVE ACTION/CERCLA REMOVAL ACTION

GM POWERTRAIN BEDFORD PLANT, BEDFORD, INDIANA



Looking west and east from Bailey Scales Road



CREEK RESTORATION

RCRA CORRECTIVE ACTION/CERCLA REMOVAL ACTION

GM POWERTRAIN BEDFORD PLANT, BEDFORD, INDIANA



Property south of Broomsage Road restoration



CREEK RESTORATION

RCRA CORRECTIVE ACTION/CERCLA REMOVAL ACTION

GM POWERTRAIN BEDFORD PLANT, BEDFORD, INDIANA



Restoration north of Broomsage Road



CREEK RESTORATION

RCRA CORRECTIVE ACTION/CERCLA REMOVAL ACTION

GM POWERTRAIN BEDFORD PLANT, BEDFORD, INDIANA





CREEK RESTORATION

RCRA CORRECTIVE ACTION/CERCLA REMOVAL ACTION

GM POWERTRAIN BEDFORD PLANT, BEDFORD, INDIANA





CREEK EXCAVATION STATUS

RCRA CORRECTIVE ACTION/CERCLA REMOVAL ACTION

GM POWERTRAIN BEDFORD PLANT, BEDFORD, INDIANA





CREEK EXCAVATION STATUS

RCRA CORRECTIVE ACTION/CERCLA REMOVAL ACTION

GM POWERTRAIN BEDFORD PLANT, BEDFORD, INDIANA



Restoration east of Peerless Road



CREEK EXCAVATION STATUS

RCRA CORRECTIVE ACTION/CERCLA REMOVAL ACTION

GM POWERTRAIN BEDFORD PLANT, BEDFORD, INDIANA



Excavation west of Peerless Road



BORROW SOURCE AREA

RCRA CORRECTIVE ACTION/CERCLA REMOVAL ACTION

GM POWERTRAIN BEDFORD PLANT, BEDFORD, INDIANA

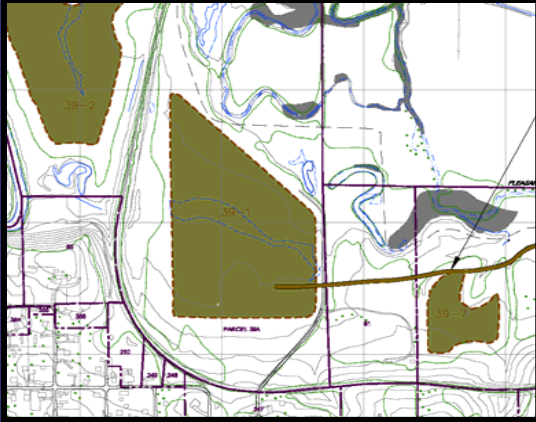



TRUCK TRAFFIC ROUTES

RCRA CORRECTIVE ACTION/CERCLA REMOVAL ACTION

GM POWERTRAIN BEDFORD PLANT, BEDFORD, INDIANA

- For several months road traffic had been minimized.
- Regular truck traffic to move the soils has resumed.
- You will notice an increase in truck traffic through the summer months as we reach completion of the excavation and soil transportation activities and as we bring in clean rock to restore the creek east of Peerless Road.
- GM will be patching/paving roads as required now that asphalt plants have re-opened.
- CRA is continually monitoring driver safety of truckers.
- Truck Traffic Issues:
Katie Kamm - (812) 279-0977

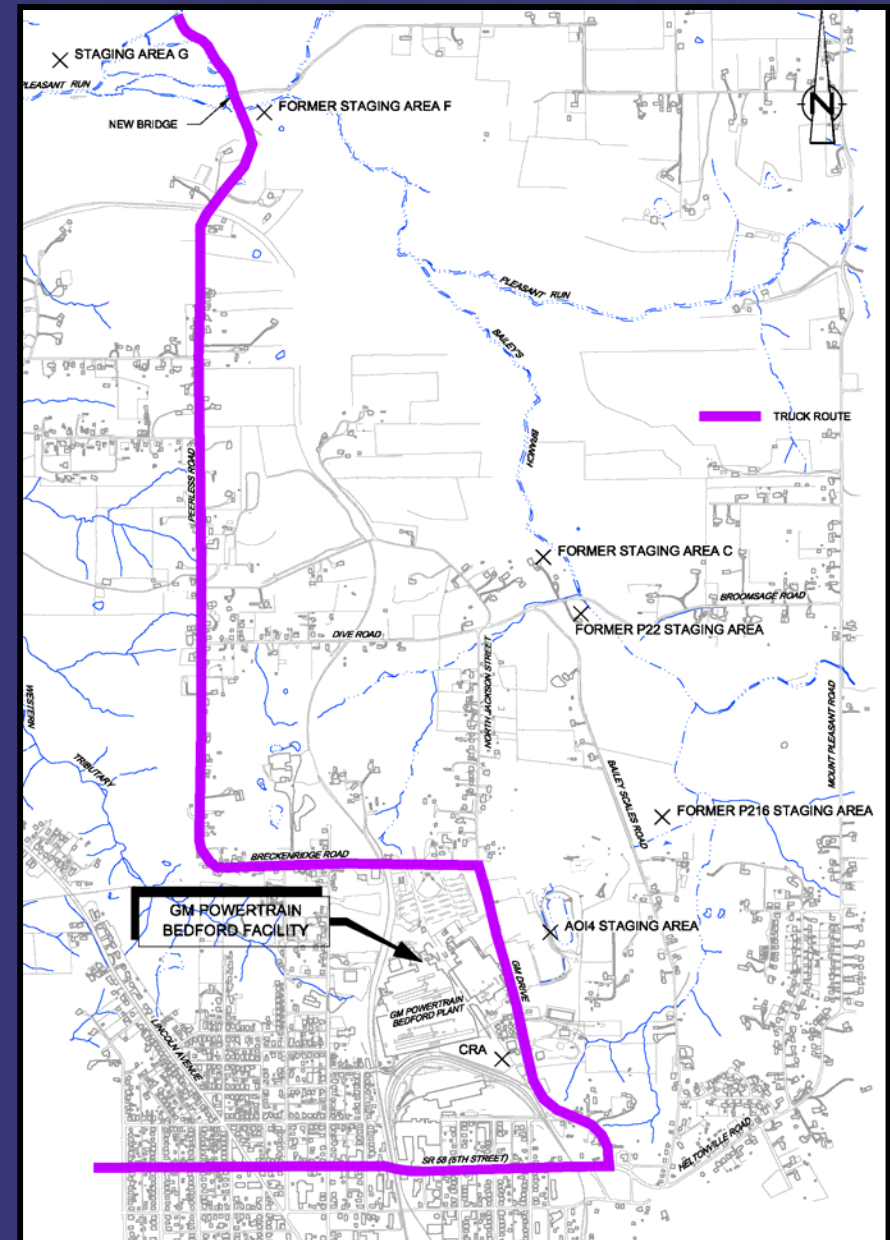



SEEPS AND SPRINGS

RCRA CORRECTIVE ACTION/CERCLA REMOVAL ACTION

GM POWERTRAIN BEDFORD PLANT, BEDFORD, INDIANA

- Investigation at a spring south of Broomsage Road is ongoing. Installation of coreholes and the dye-trace study are complete.
- Monitoring will continue to be conducted at least quarterly and low or high flow samples will be collected as conditions allow.





RCRA CORRECTIVE ACTION

RCRA CORRECTIVE ACTION/CERCLA REMOVAL ACTION

G M P O W E R T R A I N B E D F O R D P L A N T , B E D F O R D , I N D I A N A

- RCRA Corrective Action
 - Conducted under a performance-based agreement with the U.S. EPA Region V. The agreement was signed on March 20, 2001 and amended on October 1, 2002.
 - Continuing to perform soil and groundwater investigation
 - Installed new groundwater wells and completed new round of groundwater sampling
 - Dye investigation
 - Implementing Interim Measures
 - East Plant Area
 - West Plant Area



East Plant Area Interim Measure

- Re-use of low PCB Removal Action soil
 - ongoing
- Select soil removal
 - >50 PPM removal complete in the East Plant Area and placed into the Vault
- >50 PPM Landfill Vault
 - Permanent cover still to be placed
- Cover System
 - Grading and clay placement is ongoing
- Perimeter Groundwater Collection System
 - Design being finalized
 - Interim groundwater collection ongoing
- AOI 8 Collection System
 - Interim recovery system to be installed
 - Final design to be finalized
- Long-term maintenance and monitoring
 - Following construction

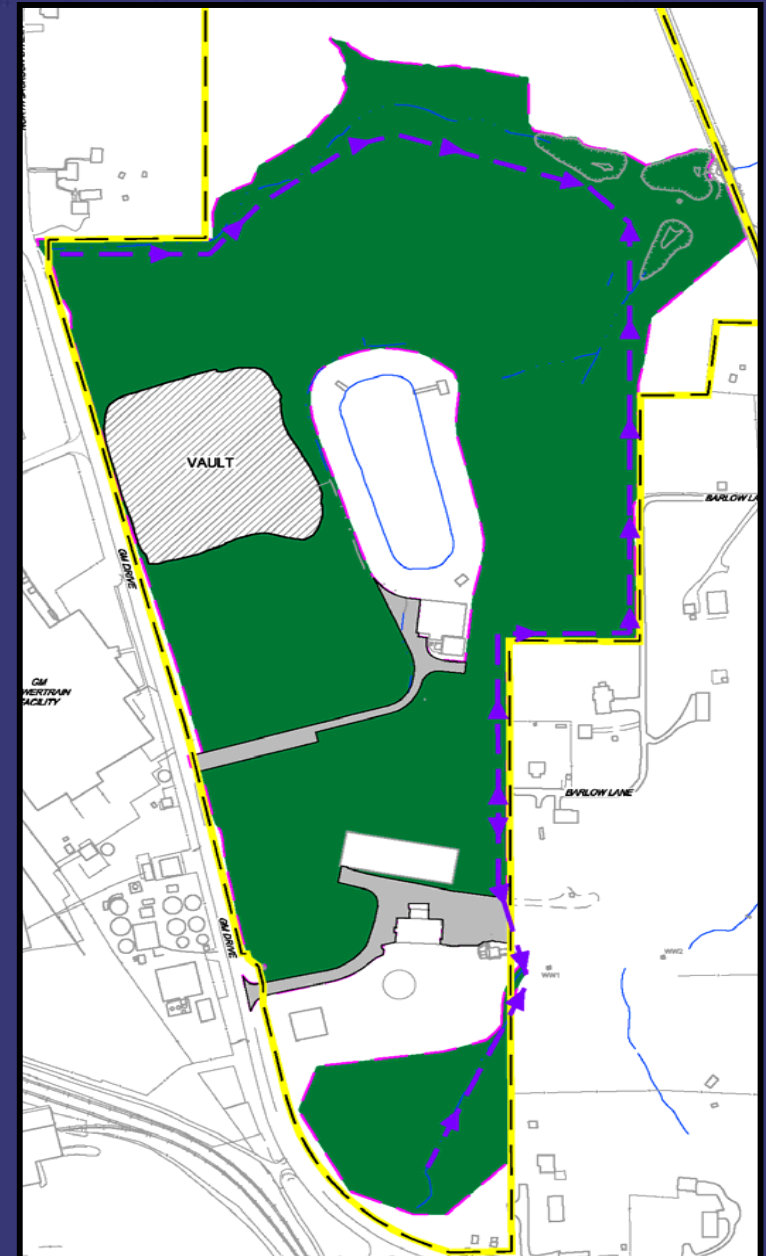



EAST PLANT AREA

RCRA CORRECTIVE ACTION/CERCLA REMOVAL ACTION

GM POWERTRAIN BEDFORD PLANT, BEDFORD, INDIANA





- Excavation of >50 ppm material is complete
- Excavation of <50 ppm on adjacent parcels nearly complete
- Filling and cover construction to commence summer 2008





WEST PLANT AREA

RCRA CORRECTIVE ACTION/CERCLA REMOVAL ACTION

GM POWERTRAIN BEDFORD PLANT, BEDFORD, INDIANA

- Corner sewer work nearly complete





WEST PLANT AREA

RCRA CORRECTIVE ACTION/CERCLA REMOVAL ACTION

GM POWERTRAIN BEDFORD PLANT, BEDFORD, INDIANA

- Excavation in front of plant to start in summer





NORTHERN TRIBUTARY

RCRA CORRECTIVE ACTION/CERCLA REMOVAL ACTION

GM POWERTRAIN BEDFORD PLANT, BEDFORD, INDIANA





UPCOMING RCRA ACTIVITIES

RCRA CORRECTIVE ACTION/CERCLA REMOVAL ACTION

G M P O W E R T R A I N B E D F O R D P L A N T , B E D F O R D , I N D I A N A

UPCOMING ACTIVITIES 2008

- Implement West Plant Area IM
- Complete transfer of soil from creek areas to East Plant Area
- Landfill Vault closure
- Complete geophysics and final design of the perimeter collection trench system
- Continue RFI groundwater monitoring



COMMUNITY RELATIONS ACTIVITIES

RCRA CORRECTIVE ACTION/CERCLA REMOVAL ACTION

GM POWERTRAIN BEDFORD PLANT, BEDFORD, INDIANA

- Community meetings are held on a quarterly basis.
 - Presentations have been and will continue to be posted to the website.
 - People can always come to the field trailer and talk one-on-one.
- Next meetings will be held in September 2008



COMMUNITY RELATIONS ACTIVITIES

RCRA CORRECTIVE ACTION/CERCLA REMOVAL ACTION

G M P O W E R T R A I N B E D F O R D P L A N T , B E D F O R D , I N D I A N A

- Project website at:
<http://www.BedfordPowertrainCorrectiveAction.com>
- Quarterly Community Meetings now available on the website
- GM Community Relations Contact person is Becki Akers
The toll-free number remains (866) 223-0856
- Public Information Repository (GM Plant)
Currently by appointment
- Public Information Repository (Library)
- Community Liaison Panel (CLP)
- Periodic information sessions
- Periodic Project Fact Sheets (twenty issued to date)
- Truck Traffic Issues: Katie Kamm – (812) 279-0977